

**EMHAS Relocation and ED Expansion  
Guelph General Hospital  
Guelph, Ontario**

Addendum No: 1  
Date: June 14, 2024

---

This addendum is to be read with and constitutes part of the tender document.

---

**Instructions:**

1. Amend your copy of the tender/quotation/proposal in accordance with the detail below
2. Retain one copy for your file; sign and return a second copy and attach to your submission as confirmation that the Addendum was taken into account in your bid submission.
3. Failure to sign and return this form may result in a non-compliant bid.

**Details of the Addendum:**

- A- Architectural specification: section 00 01 10 - Table of Contents - [ADD1]
- B- Architectural drawings A303.1, A803, A805, A2000 & A2001
  - a. Sheet # A303.1
    - i. Add a reference to WIN05
    - ii. Revise the note for the extent of work on the L2 roof and the south wall.
  - b. Sheet # A803
    - i. Add ice machine to room 1085 (note ice machine is already included on the FF&E)
    - ii. Revise millwork
  - c. Sheet # A805
    - i. Add ice machine to room 3275 (note ice machine is already included on the FF&E)
    - ii. Revise millwork
    - iii. Revise glassing type for 3450A, detail 1.4/A805
  - d. Sheet A2000
    - i. Revise door frame types
  - e. Sheet A2001
    - i. Revise the glassing type for the screen 3450A
    - ii. Add frame type FP2A
    - iii. Revise the detail number of frame type FP1
- C- Provide revisions to the mechanical and electrical scope of work in accordance with the attached mechanical and electrical addendum No.1.

End of addendum No.1

**Table of Contents**

Section revised by Addendum No.1

DR - indicates entity responsible for preparation of listed documents (see Section 00 01 05)

<u>Document Identification</u>	<u>DR</u>	<u>Pgs</u>	<u>Issued</u>
<b><u>VOLUME 1</u></b>			
<b>INTRODUCTORY INFORMATION</b>			
00 01 05 Project Directory and Seals.....	O	4	2024-06-07
00 01 10 Table of Contents .....	A	6	2024-06-07
<del>00 11 10 Prequalified Bidders.....</del>	<del>A</del>	<del>1</del>	<del>2024-06-07</del>
00 21 13 Instructions to Bidders .....	A	11	2024-06-07
00 31 00 Information Available for Review.....	O	1	2024-06-07
00 41 13 Stipulated Price Bid Form .....	A	5	2024-06-07
00 73 00 Supplementary Conditions to CCDC 2 – 2020 .....	O	33	2024-06-07
<b>DIVISION 01 - GENERAL REQUIREMENT</b>			
01 11 00 Summary of Work.....	A	7	2024-06-07
01 21 00 Allowances .....	A	2	2024-06-07
01 25 00 Substitution Procedures.....	A	3	2024-06-07
01 26 00 Contract Modification Procedures .....	A	4	2024-06-07
01 29 00 Payment Procedures .....	A	2	2024-06-07
01 31 00 Project Management and Coordination.....	A	5	2024-06-07
01 31 01 RFI Form .....	A	1	2024-06-07
01 31 14 Mechanical and Electrical Coordination .....	A	3	2024-06-07
01 31 19 Project Meetings .....	A	7	2024-06-07
01 32 00 Construction Progress Documentation.....	A	6	2024-06-07
01 33 00 Submittal Procedures.....	A	9	2024-06-07
01 35 13 Healthcare Facility Procedures .....	A	11	2024-06-07
01 42 13 Acronyms and Abbreviations .....	A	17	2024-06-07
01 45 00 Quality Requirements .....	A	8	2024-06-07
01 50 00 Temporary Facilities & Controls .....	A	9	2024-06-07
01 56 23 Hoarding.....	A	2	2024-06-07
01 60 00 Product Requirements .....	A	4	2024-06-07
01 71 00 Examination and Preparation.....	A	2	2024-06-07
01 73 00 Execution.....	A	6	2024-06-07
01 73 29 Cutting and Patching.....	A	3	2024-06-07
01 74 00 Cleaning and Waste Management .....	A	4	2024-06-07
01 77 00 Closeout Procedures .....	A	4	2024-06-07
01 78 00 Closeout Submittals.....	A	6	2024-06-07
01 78 36 Warranties .....	A	1	2024-06-07
01 79 00 Demonstration and Training.....	A	2	2024-06-07
01 91 26 Integrated Fire Protection and Life Safety Systems Testing .....	A	3	2024-06-07

**Table of Contents**

Section revised by Addendum No.1

DR - indicates entity responsible for preparation of listed documents (see Section 00 01 05)

<u>Document Identification</u>	<u>DR</u>	<u>Pgs</u>	<u>Issued</u>
<b>DIVISION 02 - EXISTING CONDITIONS</b>			
02 41 16 Demolition.....	A	7	2024-06-07
<b>DIVISION 03 - CONCRETE</b>			
03 10 00 Concrete Formwork .....	S	23	2024-06-07
03 15 00 Concrete Accessories .....	S	19	2024-06-07
03 20 00 Concrete Reinforcement .....	S	14	2024-06-07
03 30 00 Cast-in-Place Concrete.....	S	36	2024-06-07
03 35 00 Concrete Floor Finishing.....	A	4	2024-06-07
03 48 00 Architectural Precast Concrete Fabrications .....	A	4	2024-06-07
<b>DIVISION 04 - MASONRY</b>			
04 05 00 Masonry Procedure.....	A	9	2024-06-07
04 05 13 Masonry and Grout for Masonry.....	A	3	2024-06-07
04 05 19 Masonry Reinforcement and Connectors .....	A	3	2024-06-07
04 05 23 Masonry Accessories.....	A	4	2024-06-07
04 21 00 Brick Masonry Unit.....	A	1	2024-06-07
04 22 00 Concrete Masonry Unit .....	A	2	2024-06-07
<b>DIVISION 05 - METALS</b>			
05 12 00 Structural Steel .....	S	15	2024-06-07
05 31 00 Steel Roof Deck.....	S	11	2024-06-07
05 32 00 Steel Floor Deck .....	S	9	2024-06-07
05 41 13 Lateral Load-Bearing Cold-Formed Metal Framing .....	A	5	2024-06-07
05 50 00 Metal Fabrications.....	A	9	2024-06-07
05 50 10 Architectural Metal Fabrications.....	A	10	2024-06-07
05 52 16 Modular Workplace Guardrail System.....	C	7	2024.05.27
<b>DIVISION 06 - WOOD, PLASTIC, AND COMPOSITES</b>			
06 10 53 Rough Carpentry .....	A	4	2024-06-07
06 40 00 Architectural Woodwork .....	A	11	2024-06-07
<b>DIVISION 07 - THERMAL AND MOISTURE PROTECTION</b>			
07 13 26 Self-Adhering Sheet Waterproofing.....	A	4	2024-06-07
07 21 00 Thermal Insulation .....	A	5	2024-06-07
07 21 29 Sprayed-Applied Foamed-in-Place Insulation .....	A	5	2024-06-07
07 26 16 Below-Grade Vapour Barrier.....	A	3	2024-06-07
07 27 00 Air Barrier Systems.....	A	5	2024-06-07
07 42 63 Ceramic Cladding System.....	A	13	2024-06-07
07 46 16 Aluminum Panel Cladding System .....	A	10	2024-06-07
07 46 19 Metal Cladding Systems .....	A	7	2024-06-07

**Table of Contents**

Section revised by Addendum No.1

DR - indicates entity responsible for preparation of listed documents (see Section 00 01 05)

<u>Document Identification</u>	<u>DR</u>	<u>Pgs</u>	<u>Issued</u>
07 52 16 Styrene-Butadiene-Styrene (SBS) Modified			
Bituminous Membrane Roofing .....	A	15	2024-06-07
07 62 00 Metal Flashing .....	A	7	2024-06-07
07 72 00 Roof Accessories .....	A	2	2024-06-07
07 81 00 Sprayed Fire-Resistive Materials (SFRM) .....	A	3	2024-06-07
07 84 00 Joint Firestopping and Smoke Seals .....	A	7	2024-06-07
07 92 00 Joint Sealants .....	A	11	2024-06-07
07 95 00 Expansion Joint Cover Assemblies .....	A	5	2024-06-07
 <b>DIVISION 08 - OPENINGS</b>			
08 11 13 Steel Doors and Frames .....	A	12	2024-06-07
08 32 13 Interior Aluminum Sliding Doors .....	A	5	2024-06-07
08 33 23 Ambulance Garage Vehicle Doors .....	A	7	2024-06-07
08 42 26 Glass Partitions and Screens .....	A	6	2024-06-07
08 42 29 Automatic Sliding Entrance Doors .....	A	6	2024-06-07
08 44 00 Aluminum Framed Glazing Systems .....	A	17	2024-06-07
08 44 15 Fire Rated Exterior Window System .....	A	9	2024-06-07
08 71 00 Finish Hardware .....	A	5	2024-06-07
Door Hardware .....	H	89	2024-04.16
08 80 00 Glass and Glazing .....	A	14	2024-06-07
08 88 61 Vision Control Glazing .....	A	6	2024-06-07
 <b>DIVISION 09 - FINISHES</b>			
09 22 00 Metal Supports for Gypsum and Cement Board .....	A	10	2024-06-07
09 29 00 Gypsum Board .....	A	15	2024-06-07
09 31 00 Tiling .....	A	14	2024-06-07
09 51 23 Acoustical Tile Ceiling Systems .....	A	8	2024-06-07
09 54 23 Linear Metal Panels .....	A	7	2024-06-07
09 65 13 Resilient Base and Accessories .....	A	5	2024-06-07
09 65 15 Rubber Sheet Flooring .....	A	11	2024-06-07
09 65 36 Static Control Resilient Flooring .....	A	10	2024-06-07
09 67 00 Fluid-Applied Flooring .....	A	9	2024-06-07
09 69 13 Raised Flooring .....	A	7	2024-06-07
09 78 00 Interior Wall Paneling .....	A	7	2024-06-07
09 91 00 Painting .....	A	11	2024-06-07
 <b>DIVISION 10 - SPECIALTIES</b>			
10 14 00 Wayfinding Signage .....	W	11	2024-06-07
10 21 13 Phenolic Toilet Partitions .....	A	4	2024-06-07
10 26 13 Corner Guards and Wall Protection .....	A	5	2024-06-07
10 28 00 Washroom and Miscellaneous Accessories .....	A	8	2024-06-07



**Table of Contents**

Section revised by Addendum No.1

DR - indicates entity responsible for preparation of listed documents (see Section 00 01 05)

<u>Document Identification</u>	<u>DR</u>	<u>Pgs</u>	<u>Issued</u>
10 51 13 Prefinished Metal Lockers.....	A	2	2024-06-07
10 51 26 Solid Phenolic Lockers.....	A	2	2024-06-07
10 73 43 Wheelchair Shelter.....	A	2	2024-06-07
<b>DIVISION 11 - EQUIPMENT</b>			
11 72 13 Medical Headwalls.....	A	8	2024-06-07
<b>DIVISION 31 - EARTHWORK</b>			
31 05 16 Aggregates: General.....	C	4	2024.05.27
31 12 13 Site Clearing.....	C	4	2024.05.27
31 12 14 Removal of Existing Asphalt Pavement.....	C	2	2024.05.27
31 12 15 Sitework Demolition and Removal.....	C	6	2024.05.27
31 22 19 Site Earthwork.....	C	4	2024.05.27
31 23 00 Excavation and Backfill.....	A	4	2024-06-07
31 23 16 Excavation, Trenching & Backfilling.....	C	6	2024.05.27
31 23 17 Rock Removal.....	C	3	2024.05.27
31 23 24 Roadway Excavation, Embankment and Compaction ...	C	5	2024.05.27
31 25 05 Erosion and Sedimentation Control.....	C	9	2024.05.27
31 63 33 Micropiles.....	S	19	2024-06-07
<b>DIVISION 32 – EXTERIOR IMPROVEMENTS</b>			
32 11 23 Granular Base.....	C	4	2024.05.27
32 11 24 Granular Sub-Base.....	C	3	2024.05.27
32 12 16 Asphalt Paving.....	C	8	2024.05.27
32 12 17 Roadways.....	C	5	2024.05.27
32 14 13 Unit Paving.....	L	7	2024-06-07
32 16 15 Concrete Sidewalks, Curbs and Gutters.....	C	5	2024.05.27
32 17 24 Painted Pavement Markings.....	C	3	2024.05.27
32 17 26 Tactile Warning Surfacing.....	A	3	2024-06-07
32 33 00 Site Furnishings.....	A	2	2024-06-07
32 37 00 Exterior Site Furnishings.....	L	1	2024-06-07
32 91 19.1 Topsoil and Finish Grading-Landscape.....	L	5	2024-06-07
32 92 23 Sodding.....	L	3	2024-06-07
32 93 10 Trees, Shrubs, and Groundcovers.....	L	10	2024-06-07
<b>DIVISION 33 - UTILITIES</b>			
33 05 13 Manholes and Catchbasins.....	C	5	2024.05.27
33 11 16 Watermains.....	C	20	2024.05.27
33 31 13 Site Sanitary Sewerage Piping.....	C	9	2024.05.27
33 41 13 Foundation Drainage.....	A	3	2024-06-07
33 44 00 Storm Sewers.....	C	13	2024.05.27

**Table of Contents**

Section revised by Addendum No.1

DR - indicates entity responsible for preparation of listed documents (see Section 00 01 05)

<u>Document Identification</u>	<u>DR</u>	<u>Pgs</u>	<u>Issued</u>
<b><u>VOLUME 2</u></b>			
<b>INTRODUCTORY INFORMATION</b>			
00 01 05 Project Directory and Seals.....	O	4	2024-06-07
00 01 10 Table of Contents .....	A	6	2024-06-07
<b>DIVISION 21, 22, 23 AND 25 - MECHANICAL</b>			
21 05 01 Common Work Results for Mechanical .....	M	28	2024-06-07
21 12 00 Fire Protection .....	M	8	2024-06-07
22 07 00 Plumbing Insulation.....	M	5	2024-06-07
22 10 00 Plumbing Piping and Pumps .....	M	13	2024-06-07
22 40 00 Plumbing Fixtures .....	M	9	2024-06-07
22 60 00 Medical Gases .....	M	8	2024-06-07
23 05 48 Noise Control and Vibration Isolation .....	M	5	2024-06-07
23 05 93 Testing, Adjusting and Balancing for HVAC .....	M	10	2024-06-07
23 07 00 HVAC Insulation .....	M	9	2024-06-07
23 20 00 HVAC Piping and Pumps.....	M	15	2024-06-07
23 25 00 HVAC Water Treatment.....	M	4	2024-06-07
23 30 00 HVAC Air Distribution.....	M	14	2024-06-07
23 30 10 Duct Cleaning .....	M	5	2024-06-07
23 70 00 Central HVAC Equipment .....	M	3	2024-06-07
23 80 00 Decentralized HVAC Equipment .....	M	14	2024-06-07
25 00 00 Controls .....	M	33	2024-06-07
<b>DIVISION 26, 27 AND 28 - ELECTRICAL</b>			
26 05 00 Common Work Results for Electrical.....	E	23	2024-06-07
26 05 33 Basic Material and Methods.....	E	10	2024-06-07
26 08 00 Commissioning and Field Quality Control of Electrical System .....	E	12	2024-06-07
26 09 23 Lighting Control Systems .....	E	8	2024-06-07
26 20 00 Low Voltage Electrical Distribution .....	E	4	2024-06-07
26 27 90 Patient Care Areas – Wiring Methods .....	E	2	2024-06-07
26 29 00 Motors, Starters and Wiring .....	E	4	2024-06-07
26 29 23 Variable Frequency Motor Controllers.....	E	7	2024-06-07
26 50 00 Lighting.....	E	6	2024-06-07
26 80 10 Heating Cables .....	E	3	2024-06-07
27 05 28 Pathways for Communications Systems .....	E	4	2024-06-07
27 10 00 Structured Cabling .....	E	11	2024-06-07
27 51 13 Paging System.....	E	2	2024-06-07
27 52 23 Nurse Call Code Blue Systems .....	E	13	2024-06-07
27 53 13 Clock System.....	E	3	2024-06-07

**Table of Contents**

Section revised by Addendum No.1

DR - indicates entity responsible for preparation of listed documents (see Section 00 01 05)

<u>Document Identification</u>	<u>DR</u>	<u>Pgs</u>	<u>Issued</u>
28 10 00 Electronic Access Control and CCTV.....	E	4	2024-06-07
28 31 00 Fire Detection and Alarm .....	E	10	2024-06-07
28 31 00 Appendix – Integrated System Testing of Fire Protection Systems.....	E	20	May 24

**END OF SECTION**







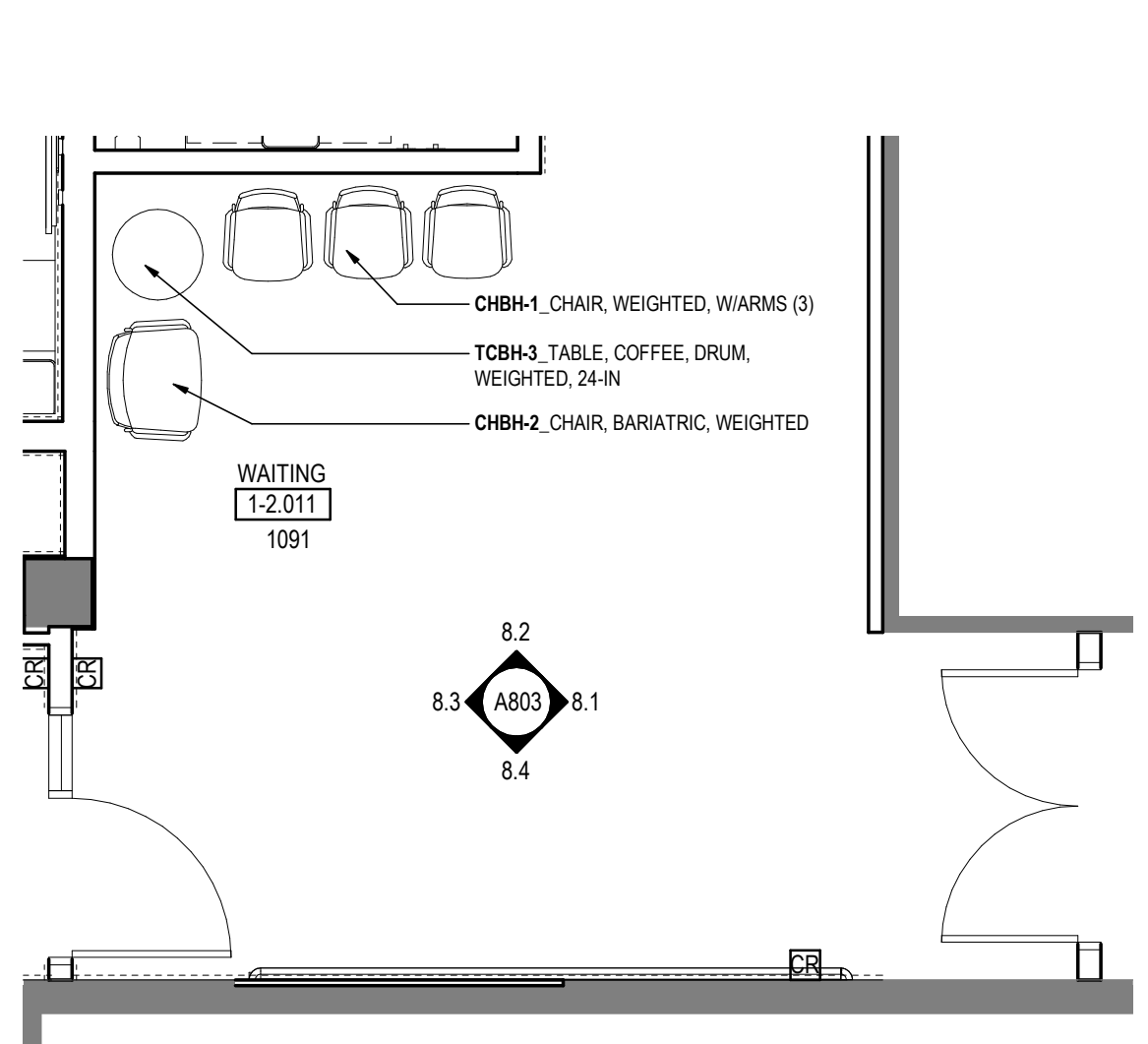

**8 FLOOR PLAN - WAITING AREA**  
A803 1:50

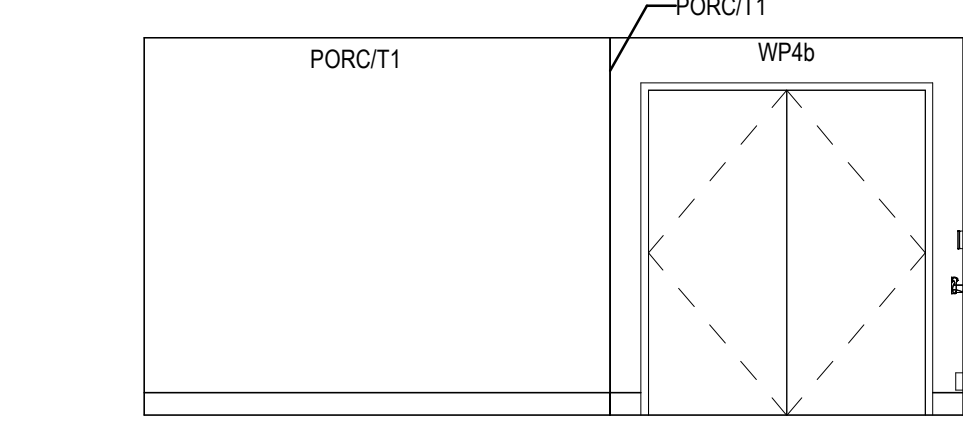

**8.1 EAST ELEV.**  
A803 1:50

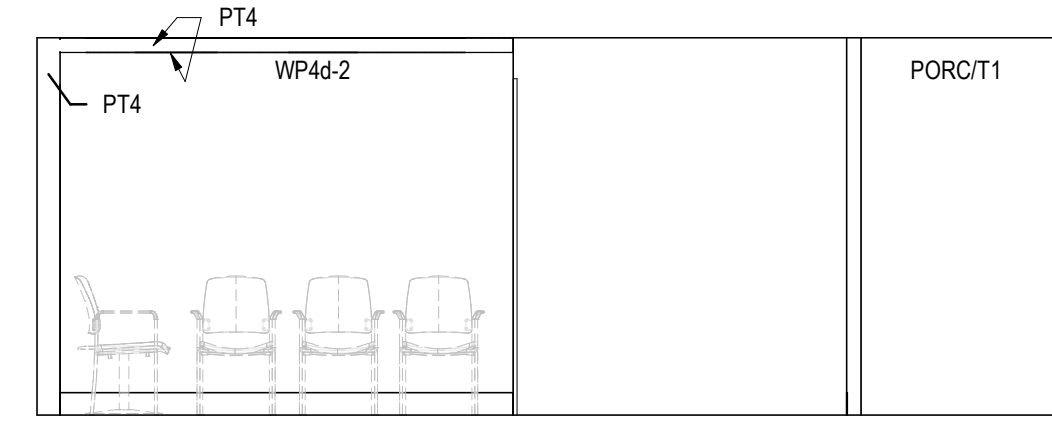

**8.2 NORTH ELEV.**  
A803 1:50

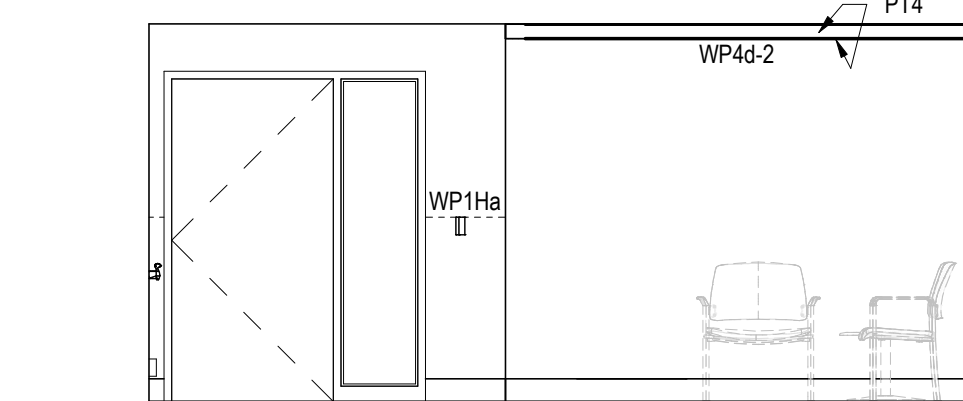

**8.3 WEST ELEV.**  
A803 1:50

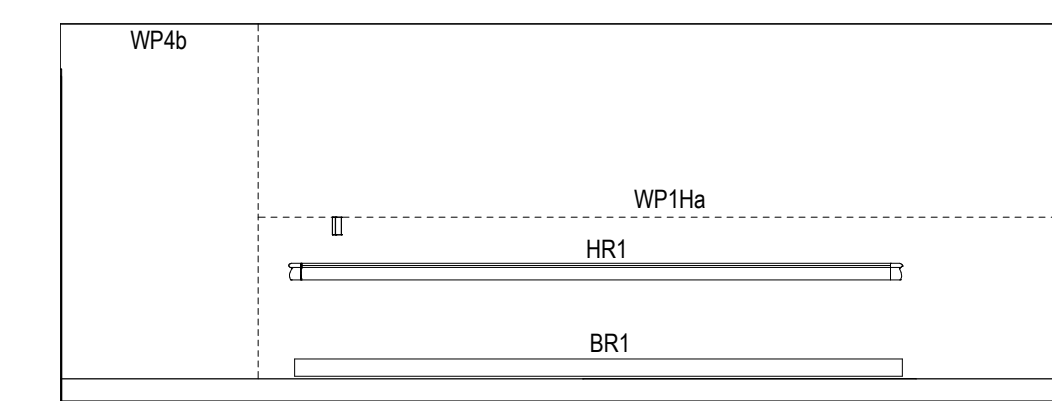

**8.4 SOUTH ELEV.**  
A803 1:50

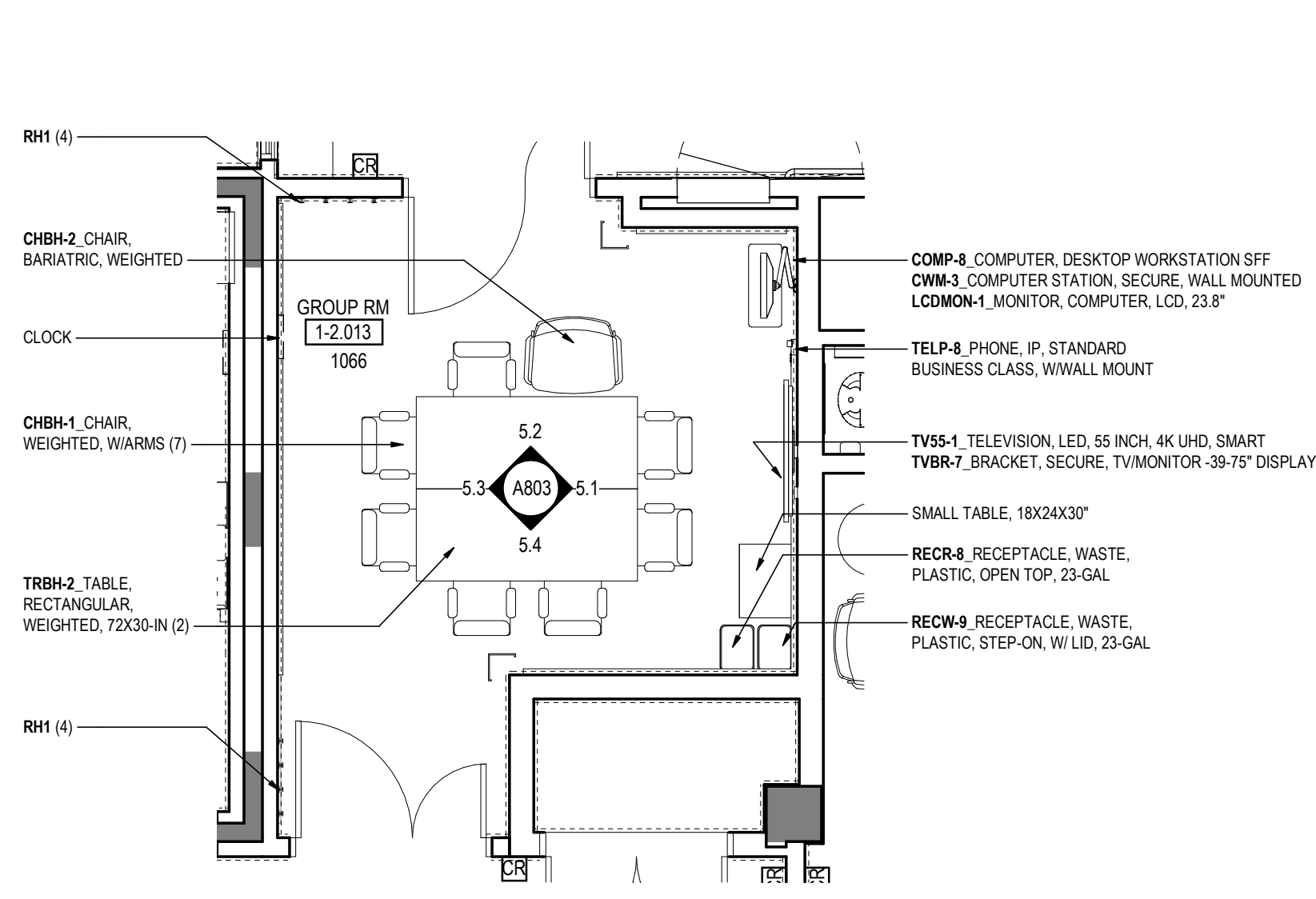

**5 FLOOR PLAN - GROUP ROOM**  
A803 1:50

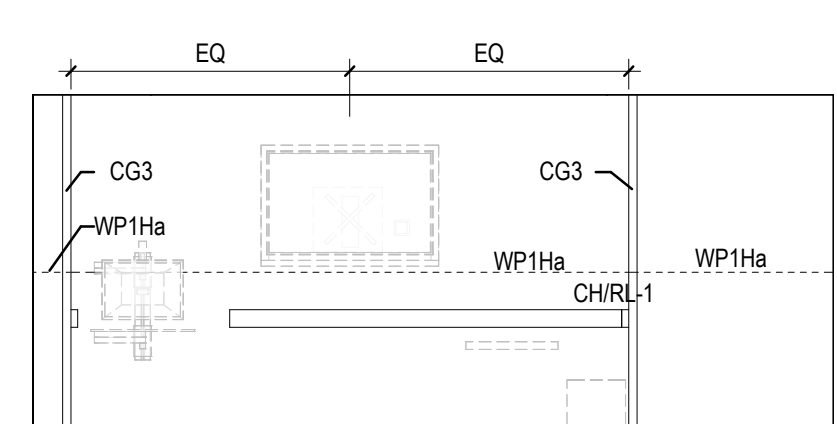

**5.1 EAST ELEV.**  
A803 1:50

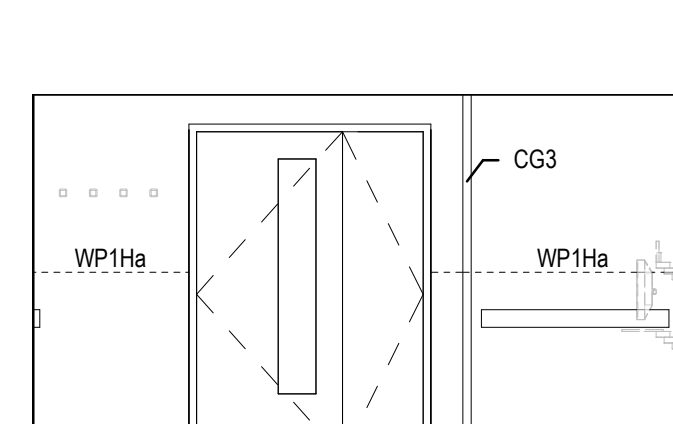

**5.2 NORTH ELEV.**  
A803 1:50

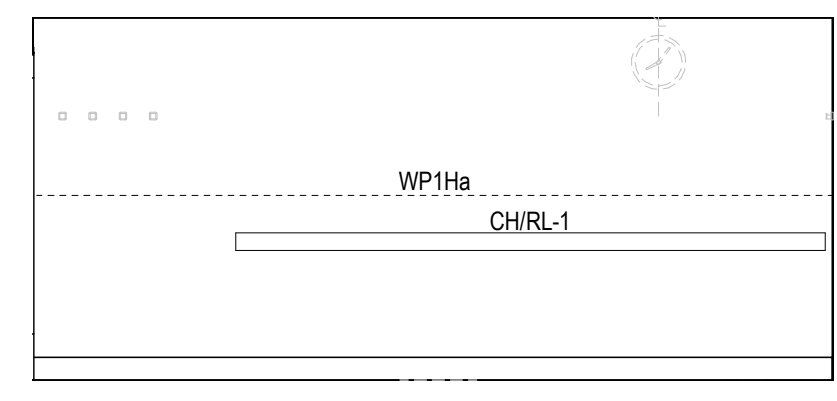

**5.3 WEST ELEV.**  
A803 1:50

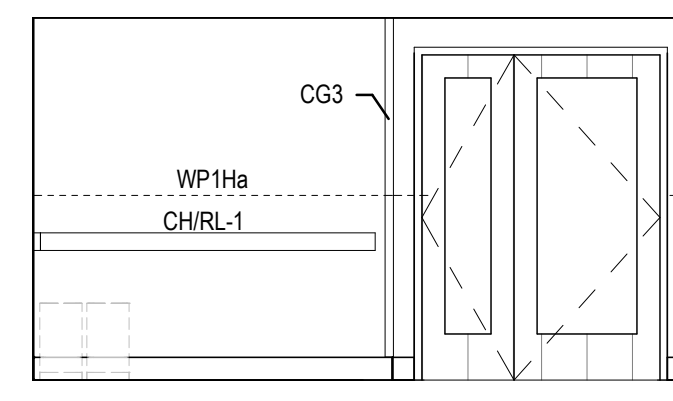

**5.4 SOUTH ELEV.**  
A803 1:50

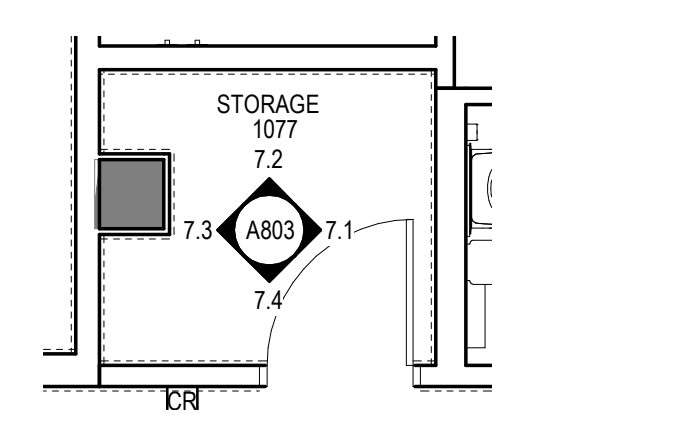

**7 FLOOR PLAN - STORAGE RM**  
A803 1:50

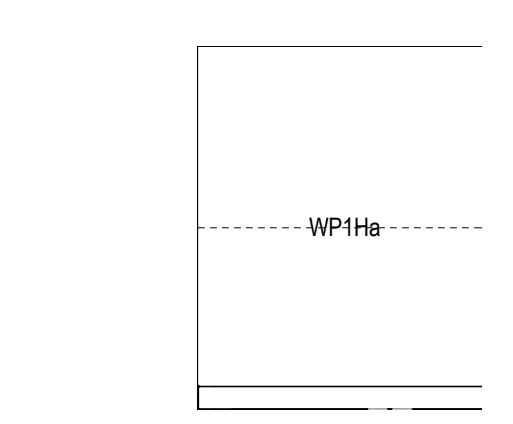

**7.1 EAST ELEV.**  
A803 1:50

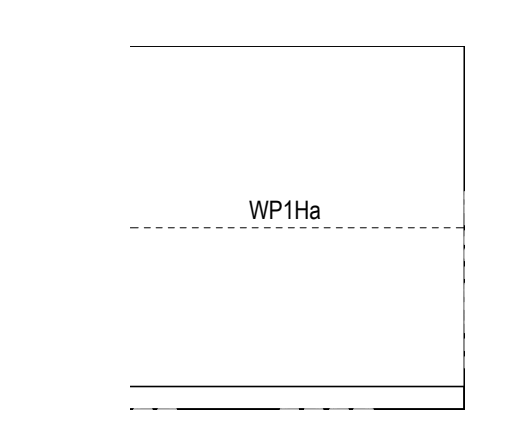

**7.2 NORTH ELEV.**  
A803 1:50

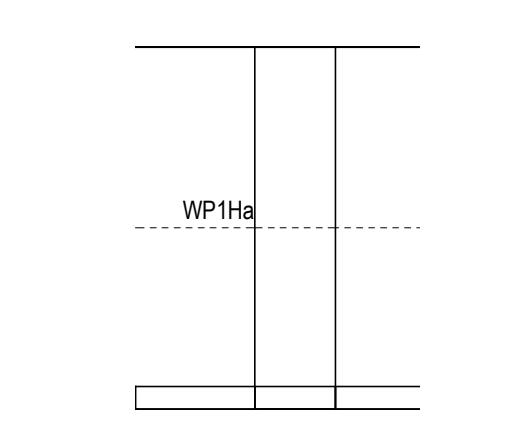

**7.3 WEST ELEV.**  
A803 1:50

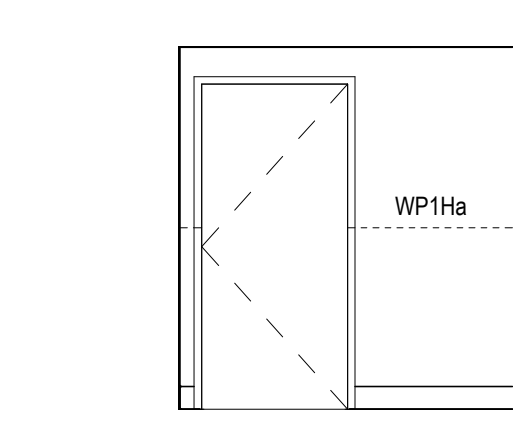

**7.4 SOUTH ELEV.**  
A803 1:50

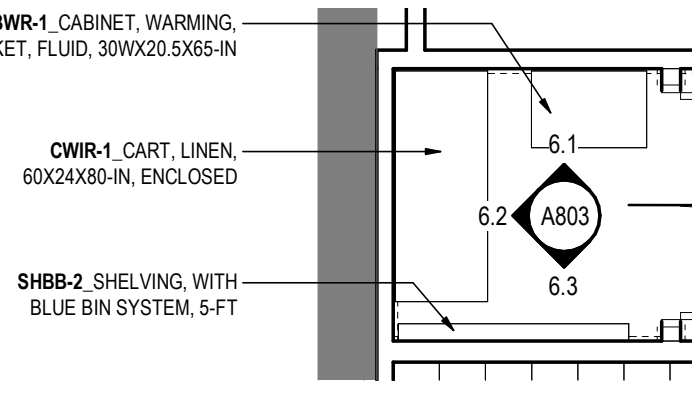

**6 FLOOR PLAN - ALCOVE, PORTABLE PATIENT LIFT**  
A803 1:50

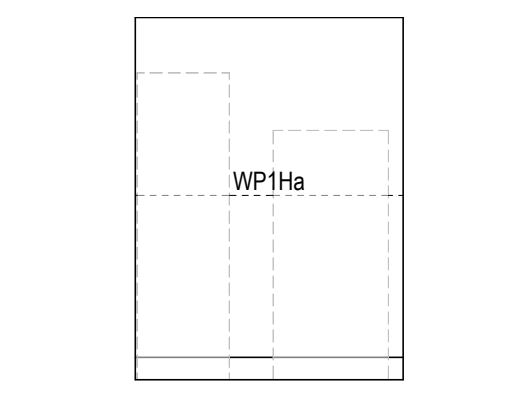

**6.1 NORTH ELEV.**  
A803 1:50

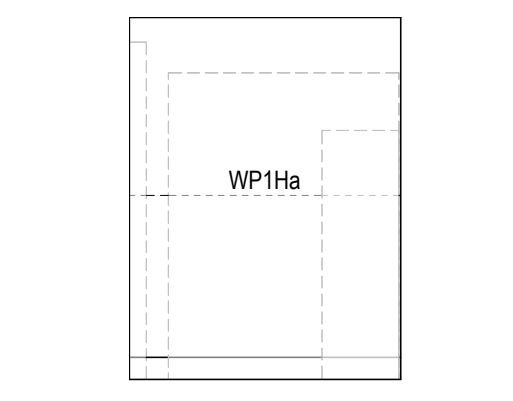

**6.2 WEST ELEV.**  
A803 1:50

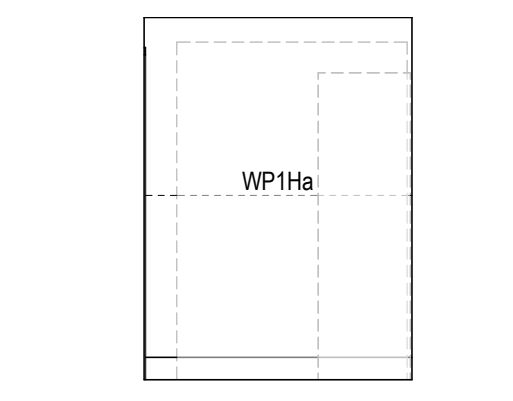

**6.3 SOUTH ELEV.**  
A803 1:50

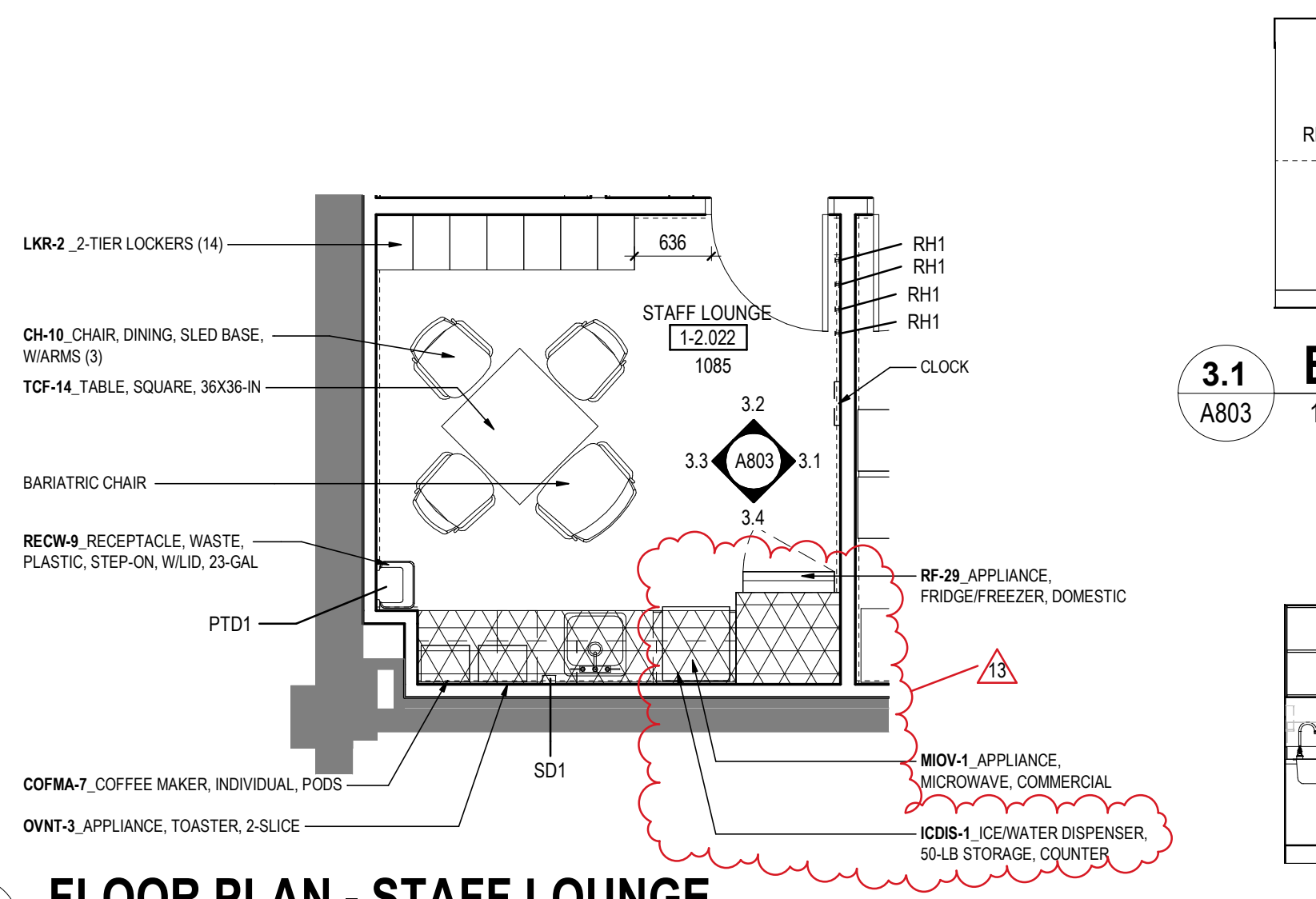

**3 FLOOR PLAN - STAFF LOUNGE**  
A803 1:50

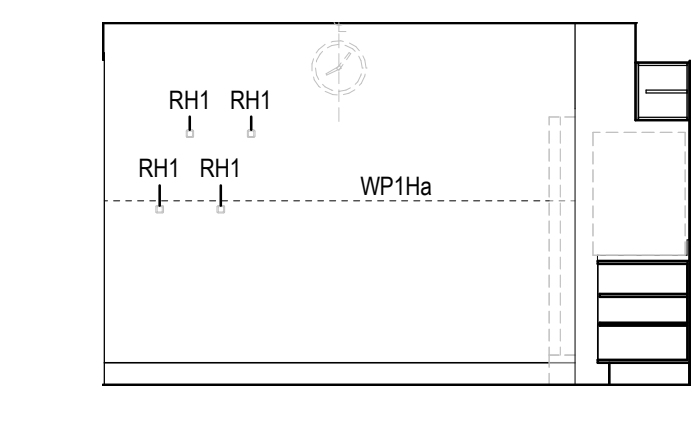

**3.1 EAST ELEV.**  
A803 1:50

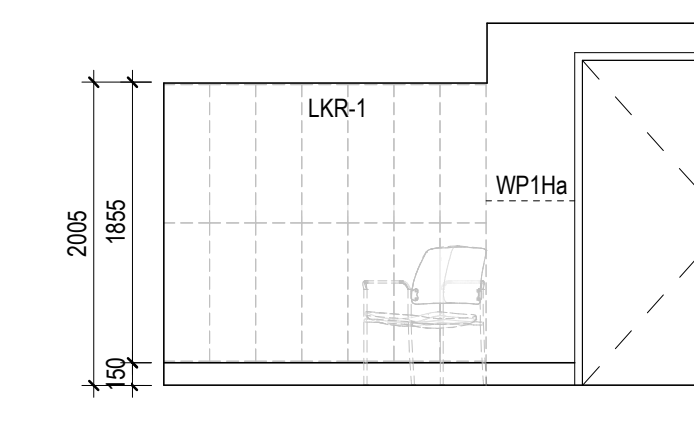

**3.2 NORTH ELEV.**  
A803 1:50

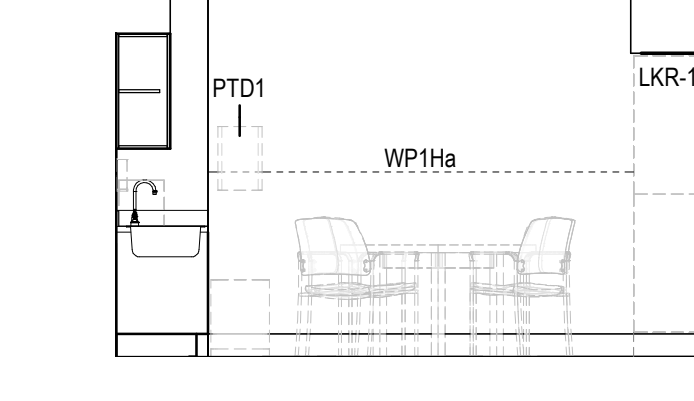

**3.3 WEST ELEV.**  
A803 1:50

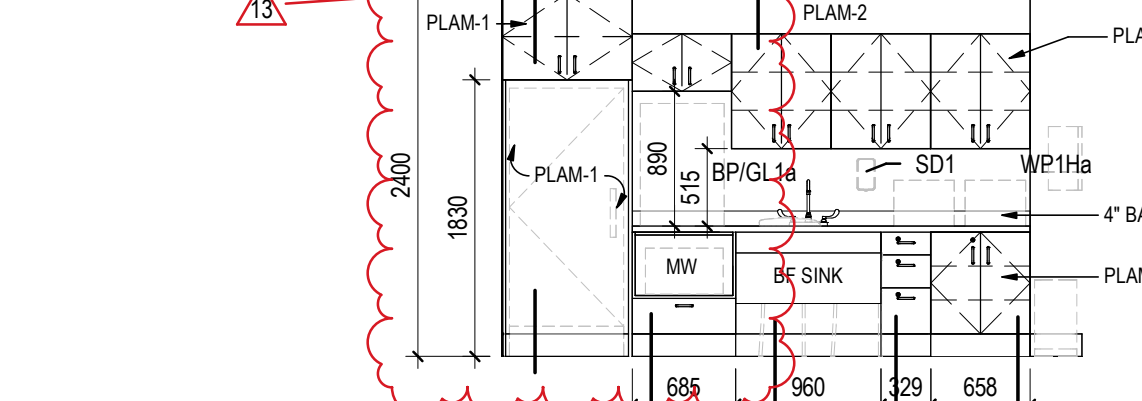

**3.4 SOUTH ELEV.**  
A803 1:50

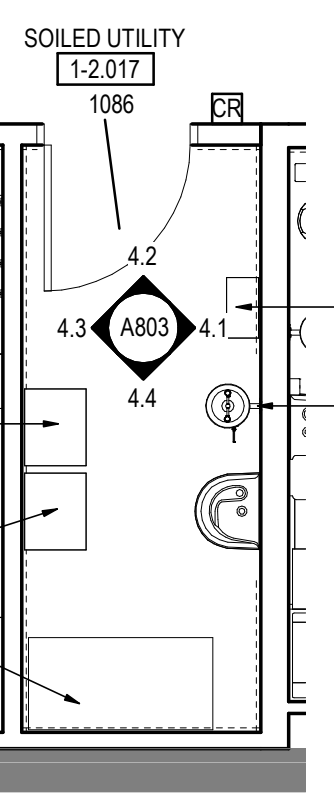

**4 FLOOR PLAN - SOILED UTILITY CLOSET**  
A803 1:50

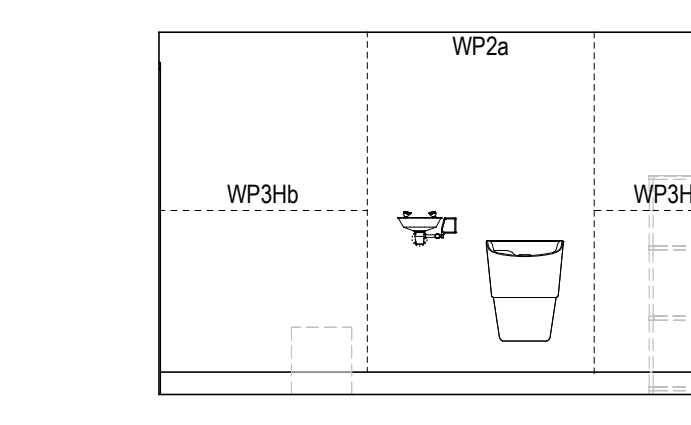

**4.1 EAST ELEV.**  
A803 1:50

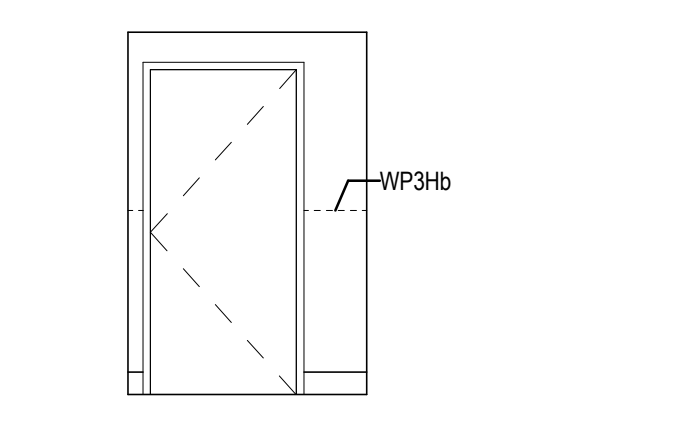

**4.2 NORTH ELEV.**  
A803 1:50

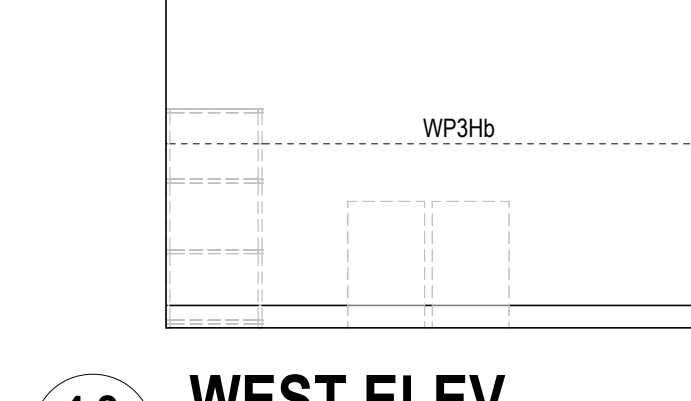

**4.3 WEST ELEV.**  
A803 1:50

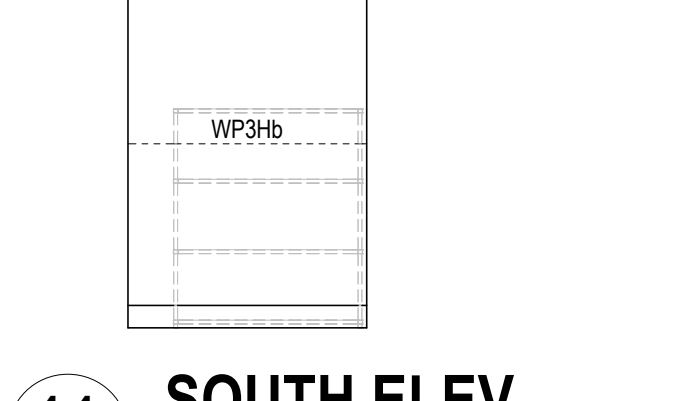

**4.4 SOUTH ELEV.**  
A803 1:50

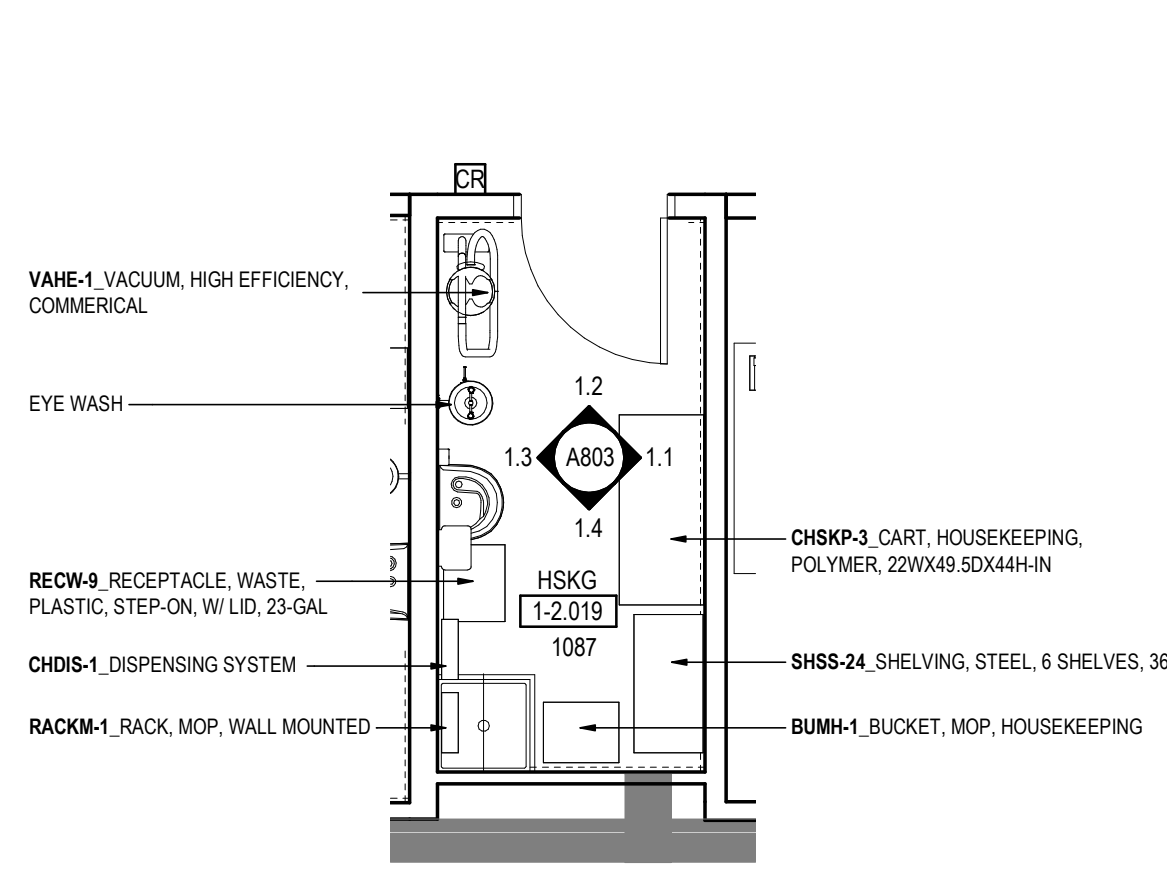

**1 FLOOR PLAN - HOUSEKEEPING CLOSET**  
A803 1:50

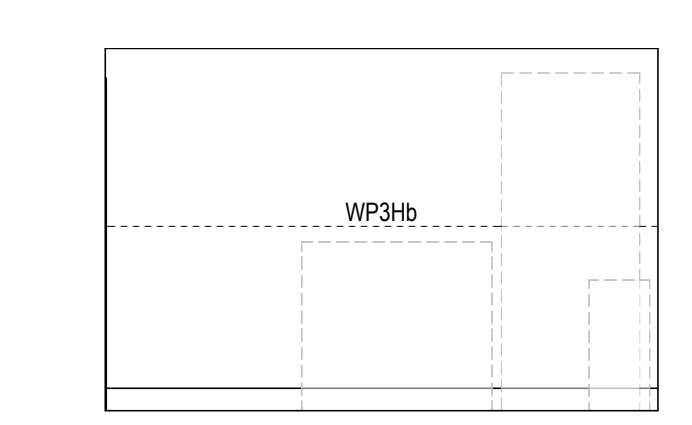

**1.1 EAST ELEV.**  
A803 1:50

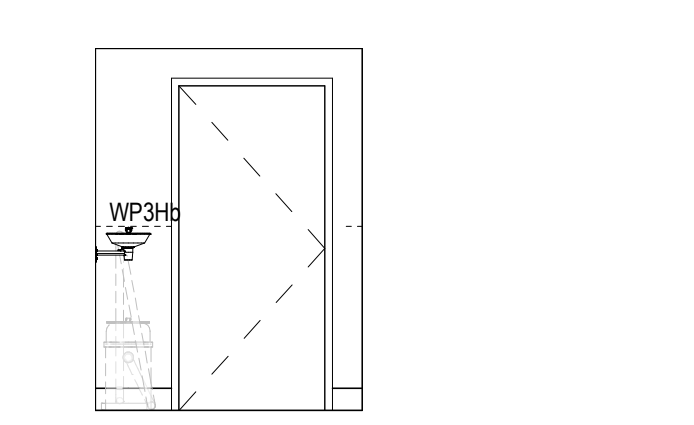

**1.2 NORTH ELEV.**  
A803 1:50

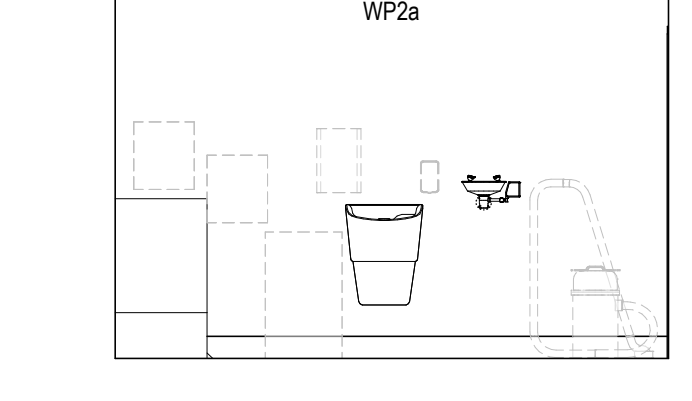

**1.3 WEST ELEV.**  
A803 1:50

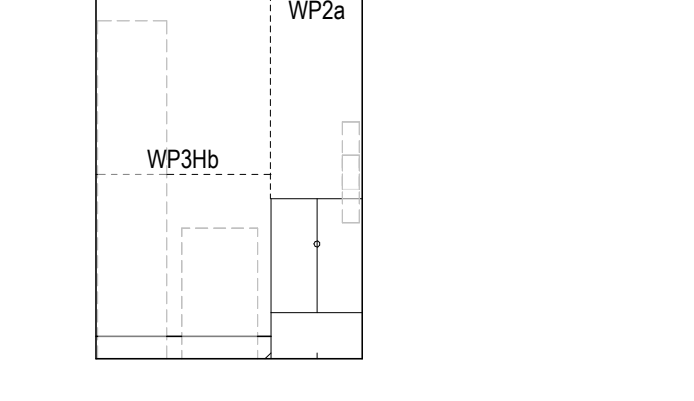

**1.4 SOUTH ELEV.**  
A803 1:50

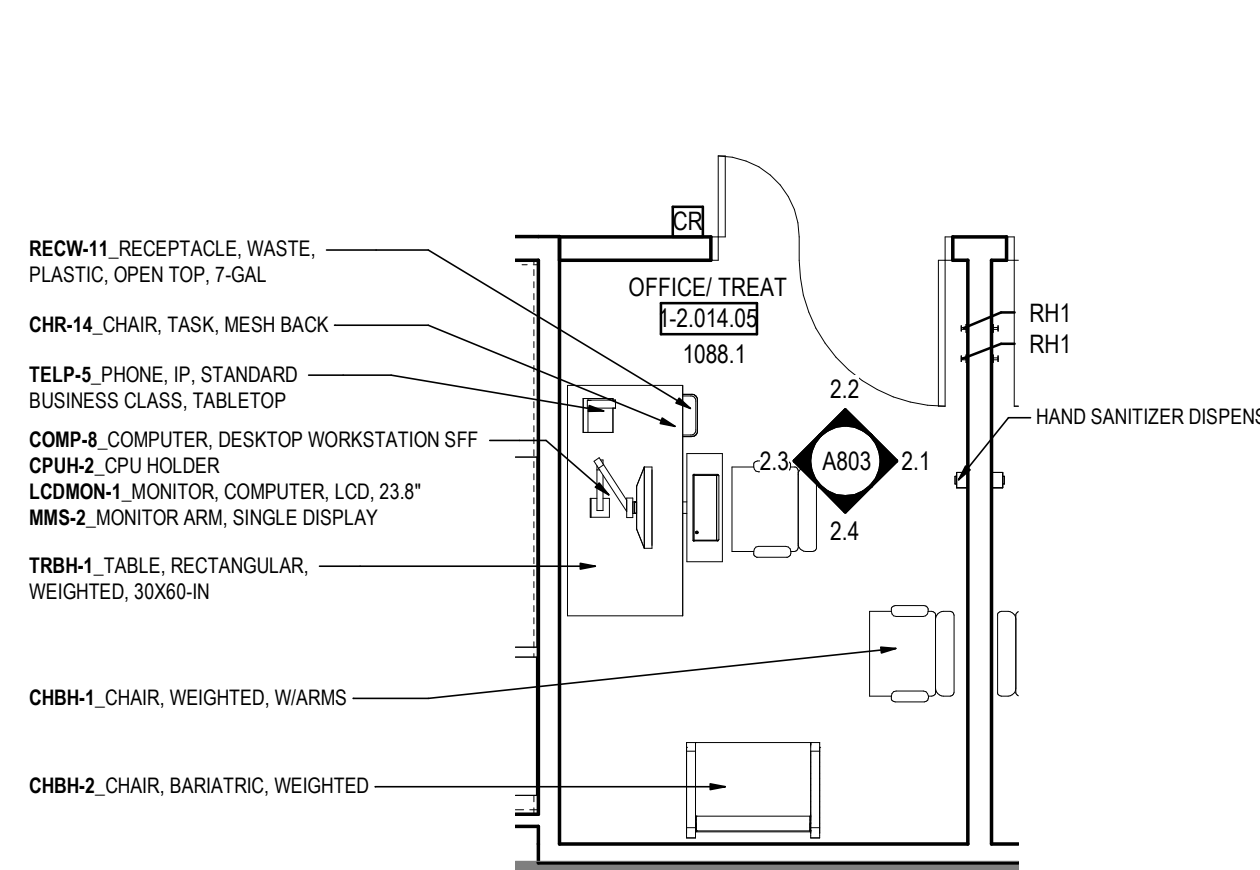

**2 FLOOR PLAN - OFFICE/TREAT (TYP.)**  
A803 1:50

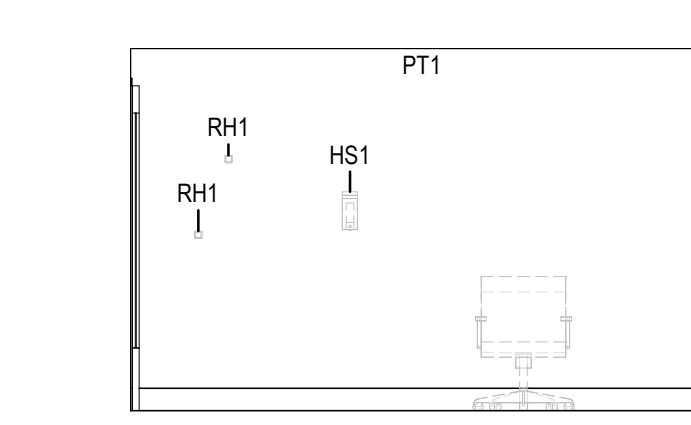

**2.1 EAST ELEV.**  
A803 1:50

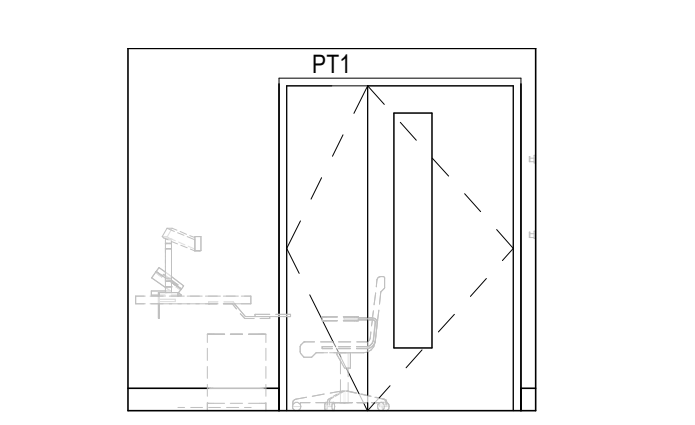

**2.2 NORTH ELEV.**  
A803 1:50

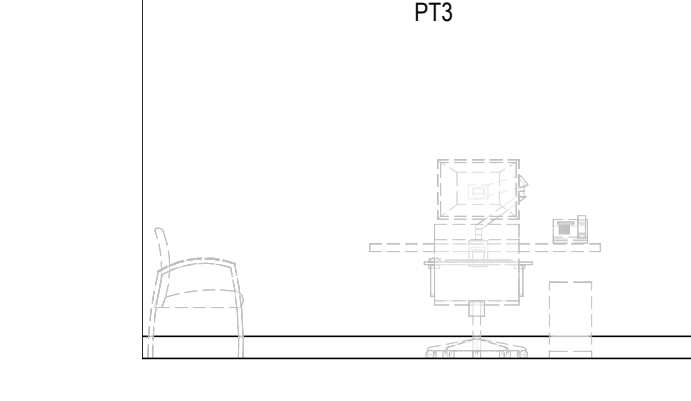

**2.3 WEST ELEV.**  
A803 1:50

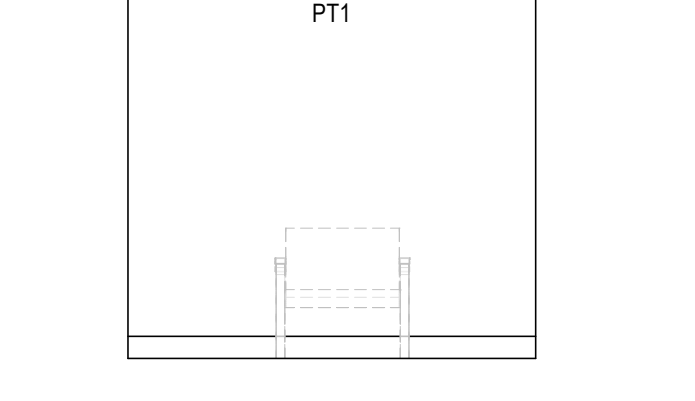

**2.4 SOUTH ELEV.**  
A803 1:50

Issue/Revision	By	App'd	YYYY.MM.DD
13 - ISSUED FOR ADDENDUM NO.1			2024.06.14
12 - ISSUED FOR TENDER			2024.06.07
11 - ISSUED FOR PRE-TENDER			2024.05.27
9 - ISSUED FOR BUILDING PERMIT			2024.03.29
8 - ISSUED FOR STAGE 2.3 MACH SUBMISSION			2024.02.23
4 - ISSUED FOR COSTING AND GCM REVIEW			2023.12.21

File Name: N/A	Author	Designer	Checker	11/15/23
	Town	Sign	Choi	YYYY.MM.DD



Client/Project  
GUELPH GENERAL HOSPITAL  
Emergency Mental Health and Addictions Services Relocation and Emergency Department Expansion  
115 DELHI STREET, GUELPH ON N1E 4J4

Title  
PHASE 1 - FF&E ENLARGED PLANS & ELEVATIONS



Notes

REFER TO DOOR SCHEDULE FOR DOOR TYPES

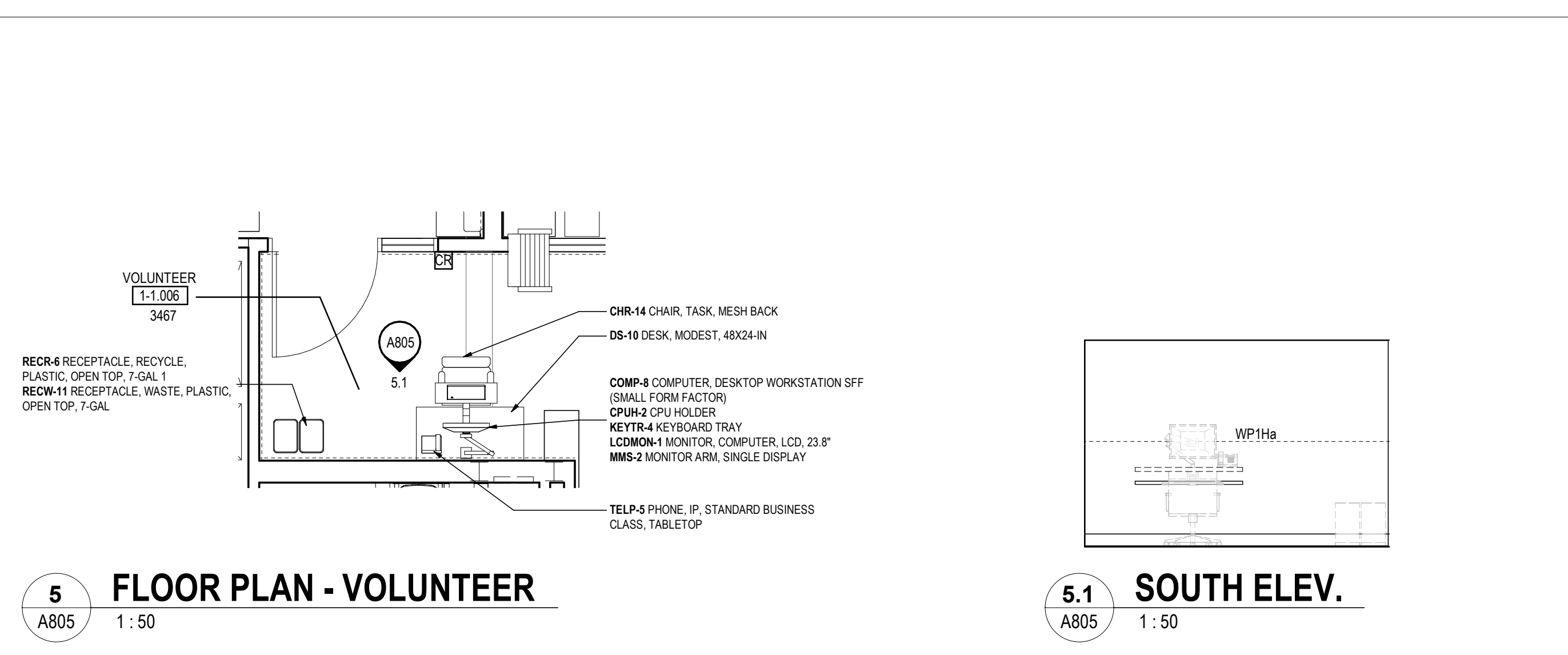
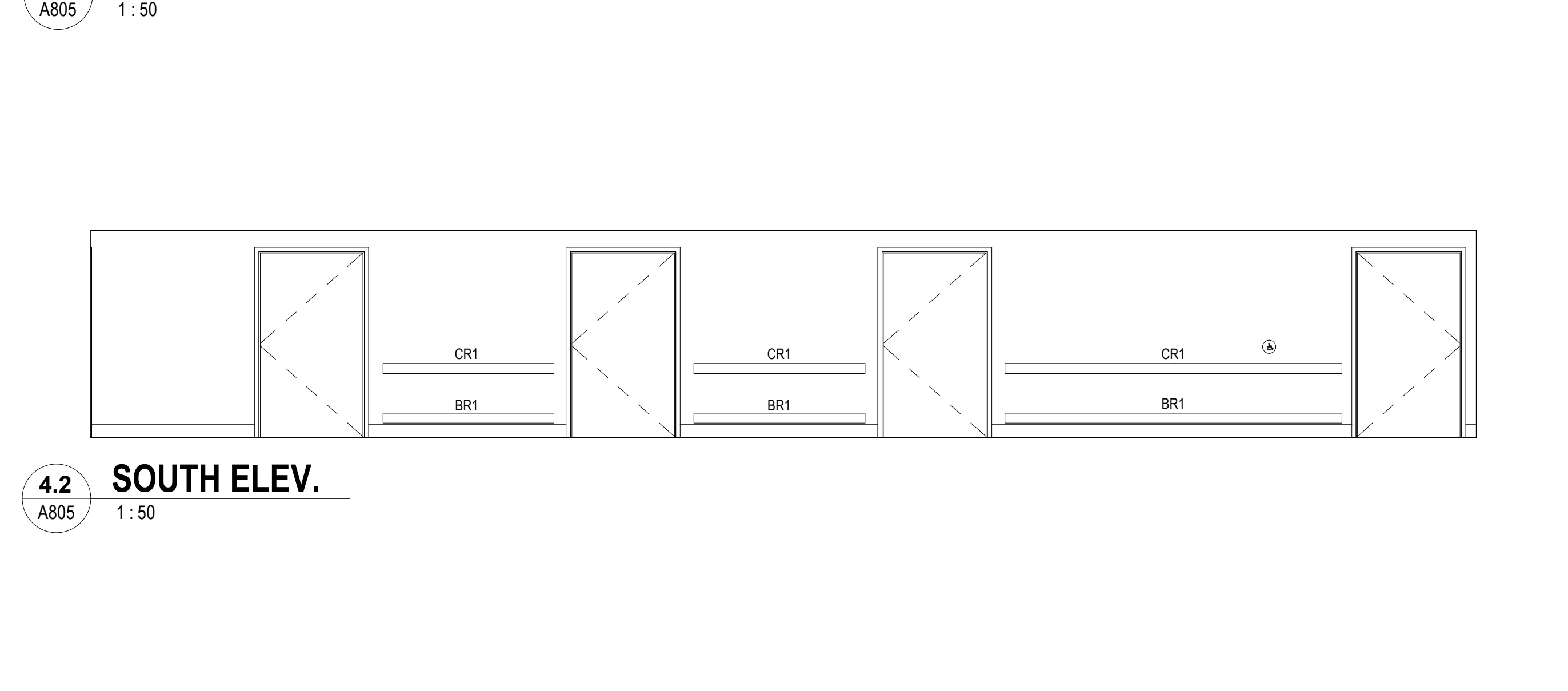
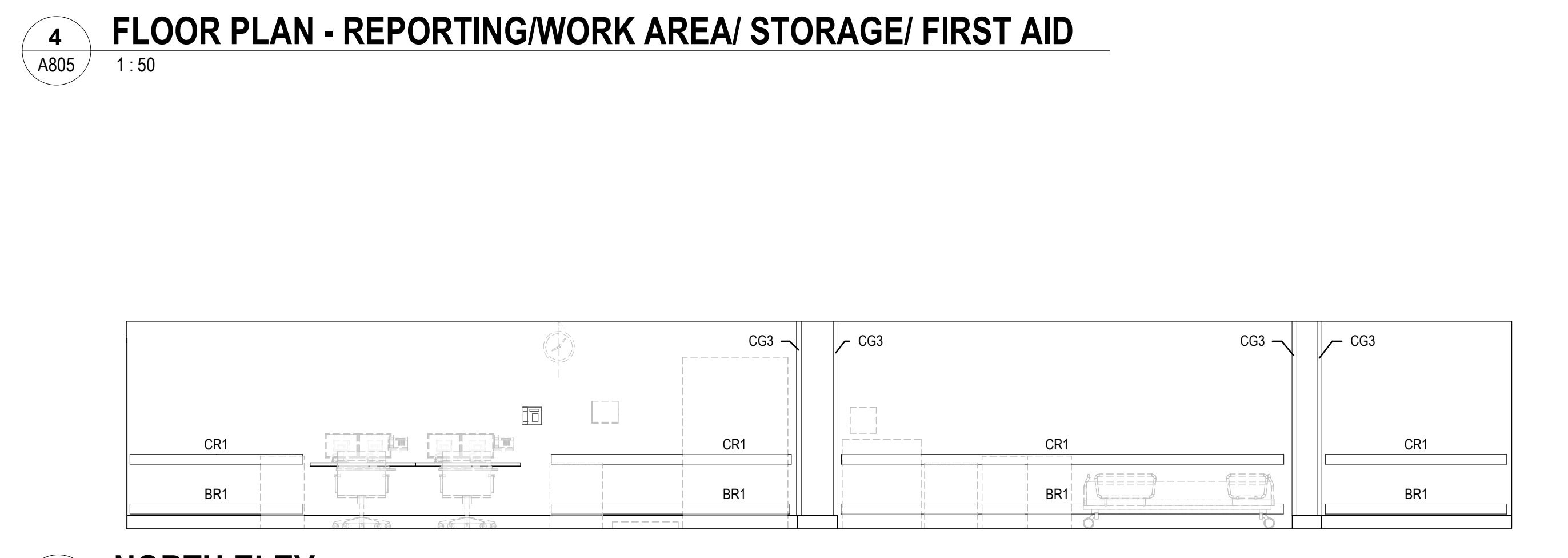
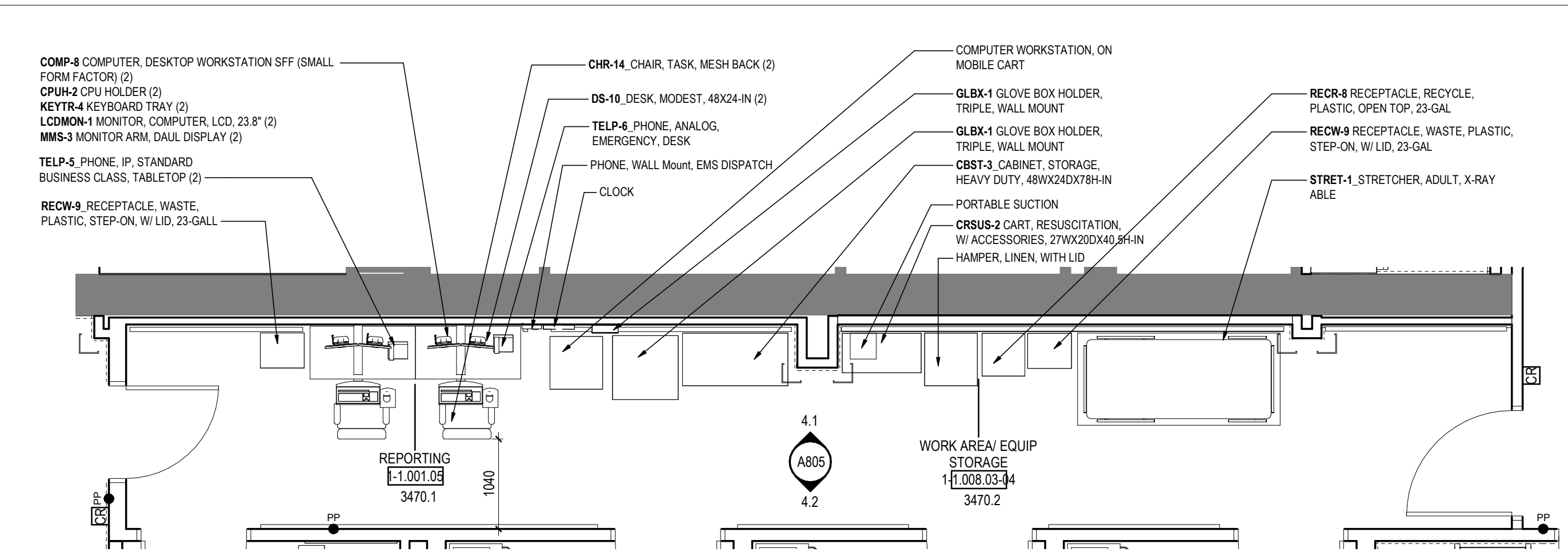
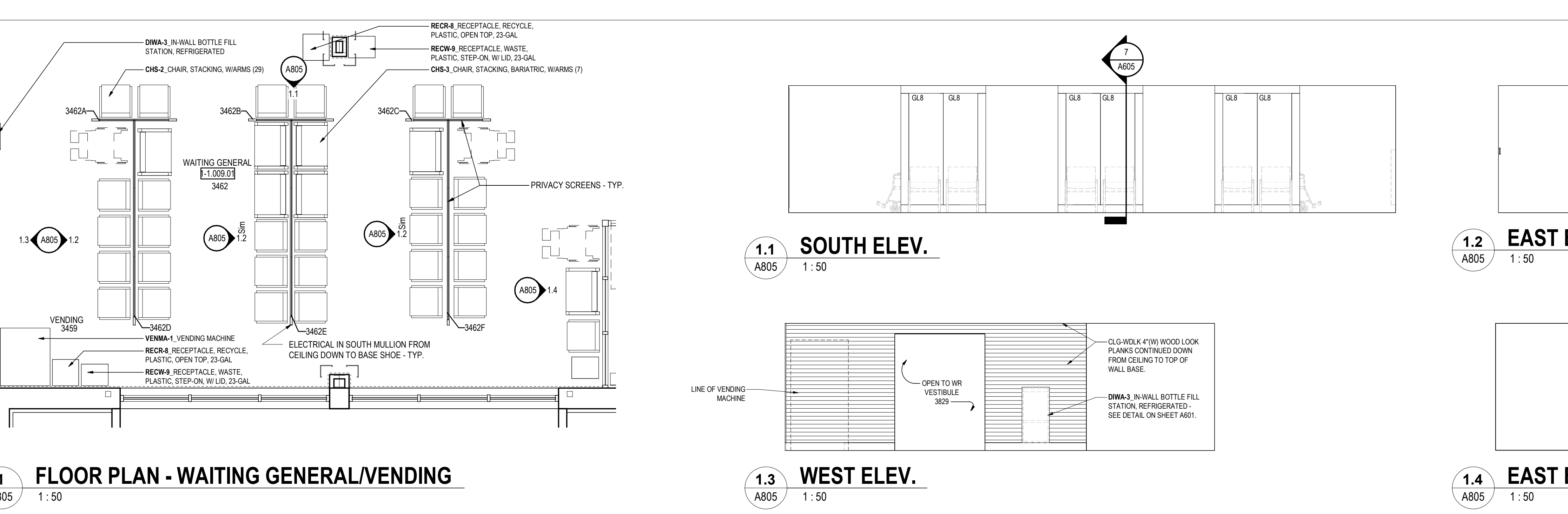
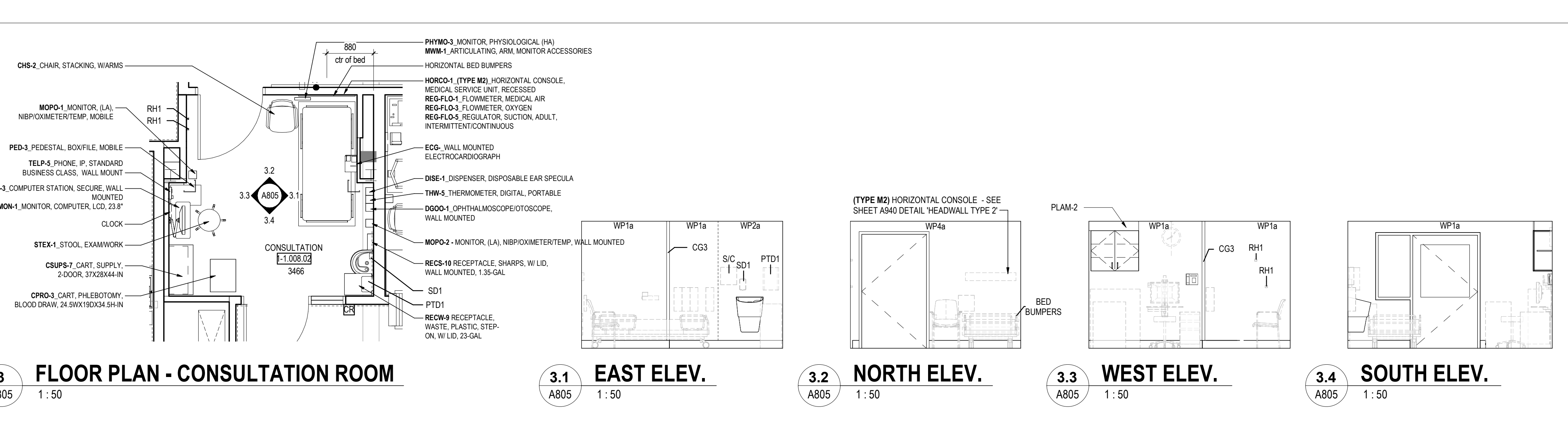
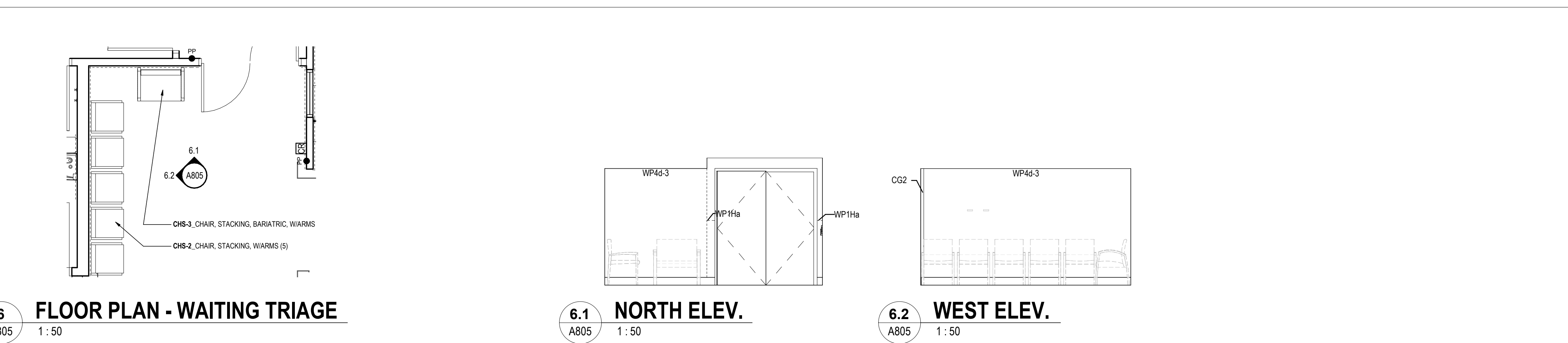
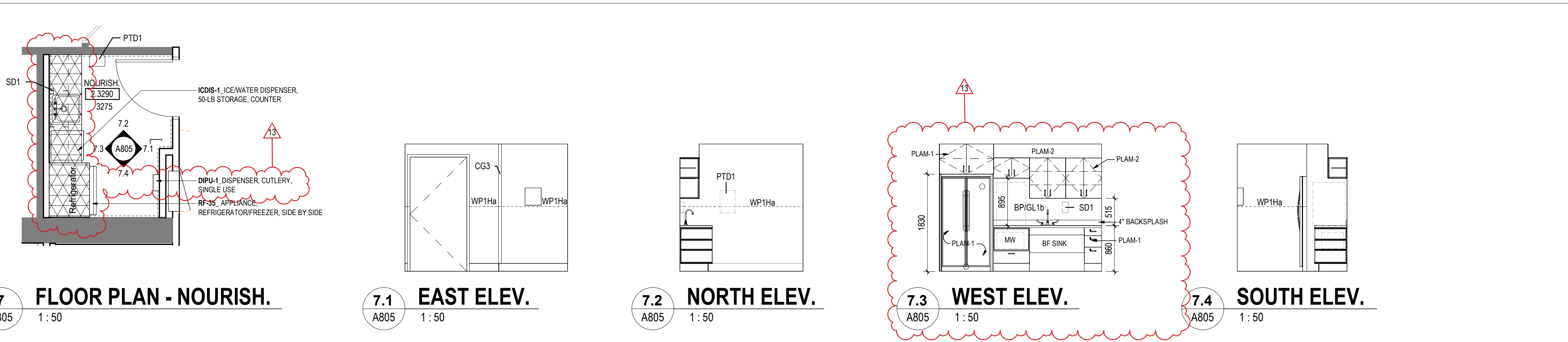

13	ISSUED FOR ADDENDUM NO.3	2024.04.14
12	ISSUED FOR TENDER	2024.06.07
11	ISSUED FOR PRE-TENDER	2024.05.27
9	ISSUED FOR BUILDING PERMIT	2024.03.28
8	ISSUED FOR STAGE 2.3 MCH SUBMISSION	2024.02.23
7	ISSUED FOR COSTING AND Q&A REVIEW	2023.12.21
5	ISSUED FOR BSA CONSTRUCTION DOCUMENTS	2023.10.26
3	ISSUED FOR MCH STAGE 2.3 SUBMISSION	2023.09.09
2	ISSUED FOR Q&A COSTING AND CLIENT REVIEW	2023.07.29

Issued/Revision By App'd YYYY.MM.DD

File Name: N/A	Author: [blank]	Designer: [blank]	Checker: [blank]	03/06/23
Permit/Seal	Dwn: [blank]	Sign: [blank]	Chk'd: [blank]	YYYY.MM.DD

Client/Project Logo



Client/Project  
GUELPH GENERAL HOSPITAL  
Emergency Mental Health and Addictions  
Services Relocation and Emergency  
Department Expansion  
115 DELHI STREET, GUELPH ON N1E 4J4

Title  
PHASE 1 - F&E ENLARGED PLANS & ELEVATIONS



GGH\_ED DOOR SCHEDULE

Level	Door No.	Room#	Room Name	Phase	Type	Panel 1...	Panel 2...	Height	Thickness	Mat1	Finish	Glass	DM1 (mm)	DM2 (mm)	DMY (mm)	Glass	Type	Mat1	Finish	Frame	Detail	Glass	Grille/L/C	Fire Label	HDWR Set	ADO	EHO	Comments	
Column1	Column2	Column3	Column4	Column5	Column6	Column7	Column8	Column9	Column10	Column11	Column12	Column13	Column14	Column15	Column16	Column162	Column17	Column18	Column19	Column20	Column21	Column22	Column23	Column24	Column25	Column27	Column28	Column30	
Level 1	1060.1	1060.1	MECHANICAL ROOM	PHASE 1	D1, D1	915	915	2150	45	HM	PT1						FR1	HM	PT2	FP2	D14								
Level 1	1065	1065	CORRIDOR	PHASE 1	D3	1120		2134	45	HM	PLAM1	GL6					FR1	HM	PT2	FP1A	D11			45					
Level 1	1065.A	1065	CORRIDOR	PHASE 1	D1,D1	1150	1150	2150	45	HM	PLAM1						FR1	HM	PT2	FP1A	D11			45					
Level 1	1066	1066	GROUP RM	PHASE 1	D2,D1	965	610	2150	45	HM	PLAM1	GL5					FR1	HM	PT2	FP1A	D11								SMALL LEAF D1, LARGE LEAF D2
Level 1	1066.A	1066	GROUP RM	PHASE 1	D2,D1	965	610	2150	45	HM	PLAM1	GL5					FR1	HM	PT2	FP1A	D11								SMALL LEAF D1, LARGE LEAF D2
Level 1	1070	1070	CORRIDOR	PHASE 1	D3	1220		2150	45	HM	PLAM1	GL2					FR1	HM	PT2	FP1A	D11								
Level 1	1070.1	1070.1	PATIENT RM	PHASE 1	D2	1220		2150	45	HM	PLAM1	GL6					FR2	HM	PT2	FP1A, FP3	D11			45					HEAVY DUTY, 16 GAUGE - STEEL STIFFENER DOOR AND 14 GAUGE FRAME, CONTINUOUS WELDED EDGES
Level 1	1070.1A	1070.1	PATIENT RM	PHASE 1	D1	610		2150	45	HM	PLAM1						FR2	HM	PT2	FP1A, FP3	D11			45					HEAVY DUTY, 16 GAUGE - STEEL STIFFENER DOOR AND 14 GAUGE FRAME, CONTINUOUS WELDED EDGES, SAME 1070...
Level 1	1070.2	1070.2	PATIENT RM	PHASE 1	D2	1220		2150	45	HM	PLAM1	GL6					FR2	HM	PT2	FP1A, FP3	D11			45					HEAVY DUTY, 16 GAUGE - STEEL STIFFENER DOOR AND 14 GAUGE FRAME, CONTINUOUS WELDED EDGES
Level 1	1070.2A	1070.2	PATIENT RM	PHASE 1	D1	610		2150	45	HM	PLAM1						FR2	HM	PT2	FP1A, FP3	D11			45					HEAVY DUTY, 16 GAUGE - STEEL STIFFENER DOOR AND 14 GAUGE FRAME, CONTINUOUS WELDED EDGES, SAME 1070...
Level 1	1070.3	1070.3	PATIENT RM	PHASE 1	D2	1220		2150	45	HM	PLAM1	GL6					FR2	HM	PT2	FP1A, FP3	D11			45					HEAVY DUTY, 16 GAUGE - STEEL STIFFENER DOOR AND 14 GAUGE FRAME, CONTINUOUS WELDED EDGES
Level 1	1070.3A	1070.3	PATIENT RM	PHASE 2	D1	610		2150	45	HM	PLAM1						FR2	HM	PT2	FP1A, FP3	D11			45					HEAVY DUTY, 16 GAUGE - STEEL STIFFENER DOOR AND 14 GAUGE FRAME, CONTINUOUS WELDED EDGES, SAME 1070...
Level 1	1070.4	1070.4	PATIENT RM	PHASE 1	D3	1220		2150	45	HM	PLAM1	GL6					FR2	HM	PT2	FP1A, FP3	D11			45					HEAVY DUTY, 16 GAUGE - STEEL STIFFENER DOOR AND 14 GAUGE FRAME, CONTINUOUS WELDED EDGES
Level 1	1070.4A	1070.4	PATIENT RM	PHASE 1	D1	610		2150	45	HM	PLAM1						FR2	HM	PT2	FP1A, FP3	D11			45					HEAVY DUTY, 16 GAUGE - STEEL STIFFENER DOOR AND 14 GAUGE FRAME, CONTINUOUS WELDED EDGES, SAME 1070...
Level 1	1070.5	1070.5	PATIENT RM	PHASE 1	D2	1220		2150	45	HM	PLAM1	GL6					FR2	HM	PT2	FP1A, FP3	D11			45					HEAVY DUTY, 16 GAUGE - STEEL STIFFENER DOOR AND 14 GAUGE FRAME, CONTINUOUS WELDED EDGES
Level 1	1070.5A	1070.5	PATIENT RM	PHASE 1	D1	610		2150	45	HM	PLAM1						FR2	HM	PT2	FP1A, FP3	D11			45					HEAVY DUTY, 16 GAUGE - STEEL STIFFENER DOOR AND 14 GAUGE FRAME, CONTINUOUS WELDED EDGES, SAME 1070...
Level 1	1070.6	1070.6	PATIENT RM	PHASE 1	D2	1220		2150	45	HM	PLAM1	GL6					FR2	HM	PT2	FP1A, FP3	D11			45					HEAVY DUTY, 16 GAUGE - STEEL STIFFENER DOOR AND 14 GAUGE FRAME, CONTINUOUS WELDED EDGES
Level 1	1070.6A	1070.6	PATIENT RM	PHASE 1	D1	610		2150	45	HM	PLAM1						FR2	HM	PT2	FP1A, FP3	D11			45					HEAVY DUTY, 16 GAUGE - STEEL STIFFENER DOOR AND 14 GAUGE FRAME, CONTINUOUS WELDED EDGES, SAME 1070...
Level 1	1077	1077	STORAGE	PHASE 1	D1	965		2150	45	HM	PT1						FR1	HM	PT2	FP1	D11					ADD			16 GAUGE - STEEL STIFFENER DOOR AND 14 GAUGE FRAME, CONTINUOUS WELDED EDGES
Level 1	1089	1089	IT CLOSET	PHASE 1	D1,D1	750	750	2150	45	HM	PT1						FR1	HM	PT2	FP1	D11								16 GAUGE - STEEL STIFFENER DOOR AND 14 GAUGE FRAME, CONTINUOUS WELDED EDGES
Level 1	1070.7	1070.7	PATIENT RM	PHASE 1	D2	1220		2150	45	HM	PLAM1	GL6					FR2	HM	PT2	FP1A, FP3	D11			45					HEAVY DUTY, 16 GAUGE - STEEL STIFFENER DOOR AND 14 GAUGE FRAME, CONTINUOUS WELDED EDGES
Level 1	1084	1084	ALC STORAGE	PHASE 1	D1,D1	750	750	2150	45	HM	PT1						FR1	HM	PT2	FP1	D11								HEAVY DUTY, 16 GAUGE - STEEL STIFFENER DOOR AND 14 GAUGE FRAME, CONTINUOUS WELDED EDGES, SAME 1070...
Level 1	1070.7A	1070.7	PATIENT RM	PHASE 1	D1	610		2150	45	HM	PLAM1						FR2	HM	PT2	FP1A, FP3	D11			45					HEAVY DUTY, 16 GAUGE - STEEL STIFFENER DOOR AND 14 GAUGE FRAME, CONTINUOUS WELDED EDGES, SAME 1070...
Level 1	1086	1086	SOLID UTILITY	PHASE 1	D1	965		2150	45	HM	PT1						FR1	HM	PT2	FP1	D11								HEAVY DUTY, 16 GAUGE - STEEL STIFFENER DOOR AND 14 GAUGE FRAME, CONTINUOUS WELDED EDGES, SAME 1070...
Level 1	1087	1087	HSKG	PHASE 1	D1	965		2150	45	HM	PT1						FR1	HM	PT2	FP1	D11								HEAVY DUTY, 16 GAUGE - STEEL STIFFENER DOOR AND 14 GAUGE FRAME, CONTINUOUS WELDED EDGES, SAME 1070...
Level 1	1070.8	1070.8	PATIENT RM	PHASE 1	D2	1220		2150	45	HM	PLAM1	GL6					FR2	HM	PT2	FP1A, FP3	D11			45					HEAVY DUTY, 16 GAUGE - STEEL STIFFENER DOOR AND 14 GAUGE FRAME, CONTINUOUS WELDED EDGES
Level 1	1070.8A	1070.8	PATIENT RM	PHASE 1	D1	610		2150	45	HM	PLAM1						FR2	HM	PT2	FP1A, FP3	D11			45					HEAVY DUTY, 16 GAUGE - STEEL STIFFENER DOOR AND 14 GAUGE FRAME, CONTINUOUS WELDED EDGES, SAME 1070...
Level 1	1071.1	1071.1	CARE TEAM STN	PHASE 1	D3	1070		2150	45	HM	PLAM1	GL2					FR1	HM	PT2	FP1A	D11								16 GAUGE - STEEL STIFFENER DOOR AND 14 GAUGE FRAME, CONTINUOUS WELDED EDGES
Level 1	1071.1A	1071.1	CARE TEAM STN	PHASE 1	D3	965		2150	45	HM	PLAM1	GL2	1110	2220	760		FR1	HM	PT2	FP1A	D11								16 GAUGE - STEEL STIFFENER DOOR AND 14 GAUGE FRAME, CONTINUOUS WELDED EDGES
Level 1	1071.2	1071.2	ALC LKNS	PHASE 1	D2	965		2150	45	HM	PLAM1	GL2					FR1	HM	PT2	FP1A	D11								HEAVY DUTY, 16 GAUGE - STEEL STIFFENER DOOR AND 14 GAUGE FRAME, CONTINUOUS WELDED EDGES
Level 1	1072	1072	WR (3PC)	PHASE 1	D1	1070		2150	45	HM	PLAM1						FR1	HM	PT2	FP9	D11					ADD			HEAVY DUTY, 16 GAUGE - STEEL STIFFENER DOOR AND 14 GAUGE FRAME, CONTINUOUS WELDED EDGES
Level 1	1074	1074	CORRIDOR	PHASE 1	D3	1220		2150	45	HM	PLAM1	GL2					FR1	HM	PT2	FP1A	D11								HEAVY DUTY, 16 GAUGE - STEEL STIFFENER DOOR AND 14 GAUGE FRAME, CONTINUOUS WELDED EDGES
Level 1	1075	1075	WR (P ACC)	PHASE 1	D1	1070		2150	45	HM	PLAM1						FR1	HM	PT2	FP9	D11					ADD			HEAVY DUTY, 16 GAUGE - STEEL STIFFENER DOOR AND 14 GAUGE FRAME, CONTINUOUS WELDED EDGES
Level 1	1076	1076	WR (3PC)	PHASE 1	D1	1070		2150	45	HM	PLAM1						FR1	HM	PT2	FP9	D11					ADD			HEAVY DUTY, 16 GAUGE - STEEL STIFFENER DOOR AND 14 GAUGE FRAME, CONTINUOUS WELDED EDGES
Level 1	1083	1083	WR (S)	PHASE 1	D1	965		2150	45	HM	PLAM1						FR1	HM	PT2	FP1A	D11								HEAVY DUTY, 16 GAUGE - STEEL STIFFENER DOOR AND 14 GAUGE FRAME, CONTINUOUS WELDED EDGES
Level 1	1085	1085	STAFF LOUNGE	PHASE 1	D1	965		2150	45	HM	PLAM1						FR1	HM	PT2	FP1A	D11								HEAVY DUTY, 16 GAUGE - STEEL STIFFENER DOOR AND 14 GAUGE FRAME, CONTINUOUS WELDED EDGES
Level 1	1088.1	1088.1	OFFICE/TREAT	PHASE 1	D2,D1	965	535	2150	45	HM	PLAM1	GL5					FR1	HM	PT2	FP1A,FP8	D11								SMALL LEAF D1, LARGE LEAF D2
Level 1	1133	1133	JANITOR	PHASE 1	D1	915		2150	45	HM	PT1						FR1	HM	PT2	FP1	D11								SMALL LEAF D1, LARGE LEAF D2
Level 1	1088.2	1088.2	OFFICE/TREAT	PHASE 1	D2,D1	965	535	2150	45	HM	PLAM1	GL5					FR1	HM	PT2	FP1A,FP8	D11								SMALL LEAF D1, LARGE LEAF D2
Level 1	1150	1150	ALCOVE STORAGE	PHASE 1	D1,D1	762	760	2150	45	HM	PT1						FR1	HM	PT2	FP1	D11								SMALL LEAF D1, LARGE LEAF D2
Level 1	1088.3	1088.3	OFFICE/TREAT	PHASE 1	D2,D1	965	535	2150	45	HM	PLAM1	GL5					FR1	HM	PT2	FP1A,FP8	D11								SMALL LEAF D1, LARGE LEAF D2
Level 1	1088.4	1088.4	OFFICE/TREAT	PHASE 1	D2,D1	965	535	2150	45	HM	PLAM1	GL5					FR1	HM	PT2	FP1A,FP8	D11								SMALL LEAF D1, LARGE LEAF D2
Level 1	1088.5	1088.5	OFFICE/TREAT	PHASE 1	D2,D1	965	535	2150	45	HM	PLAM1	GL5					FR1	HM	PT2	FP1A,FP8	D11								SMALL LEAF D1, LARGE LEAF D2
Level 1	1090.1	1090.1	INJECTION	PHASE 1	D1,D3	965	610	2150	45	HM	PLAM1	GL5					FR1	HM	PT2	FP1A	D11								SMALL LEAF D1, LARGE LEAF D2
Level 1	1090.2	1090.2	MEDICATION	PHASE 1	D1	965		2150	45	HM	PLAM1						FR1	HM	PT2	FP2A	D11								SMALL LEAF D1, LARGE LEAF D2
Level 1	1092.2A	1090.2	MEDICATION	PHASE 1	D1	965		2150	45	HM	PLAM1						FR1	HM	PT2	FP1A	D11								SMALL LEAF D1, LARGE LEAF D2
Level 1	1092.2B	1090.2	MEDICATION	PHASE 1	D1	965		2150	45	HM	PLAM1						FR1	HM	PT2	FP1A	D11						ADD		







**14 June 2024**

**Page 1 of 1**

**Plus: Re-issued Drawings M201, M202, M203 & M205**

### **ADDENDUM NO. 1**

Make the following amendments and additions to the Drawings and Specifications, and include this cost in the Contract Price.

#### **1. MECHANICAL DRAWINGS**

1. Revise plumbing to accommodate ice machines in rooms 1-2.022 & 2.3290.
2. Refer to attached re-issued drawings M201, M202, M203 & M205.

#### **2. ELECTRICAL DRAWINGS**

##### **1. Drawing E302 – Phase 1 – Part Level 3 Floor plan – Power**

1. Provide a receptacle on the west wall of Nourish 2.3290 for ice machine. Refer to mechanical drawing M205 for exact location. Feed from circuit LP-3W-G-68. Provide a 20A 1P breaker in space 68 on panel LP-3W-G.

**END OF ADDENDUM NO. 1**

Copyright Disclaimer

DO NOT SCALE THE DRAWINGS. ALL MEASUREMENTS ARE TO BE CHECKED AND VERIFIED ON SITE BY THE CONTRACTOR. ANY DISCREPANCIES ARE TO BE REPORTED TO THE CONSULTANT BEFORE PROCEEDING WITH THE WORK.  
COPYRIGHT © ALL RIGHTS RESERVED. DRAWINGS AND RELATED DOCUMENTS ARE THE COPYRIGHT OF THE CONSULTANT AND MUST BE RETURNED UPON REQUEST OR AT THE COMPLETION OF THE WORK. REPRODUCTION OF THESE DRAWINGS OR RELATED DOCUMENTS IN PART OR IN WHOLE BY ELECTRONIC OR MECHANICAL MEANS IS FORBIDDEN BY LAW WITHOUT THE PRIOR WRITTEN PERMISSION OF THE CONSULTANT.

Key Plan

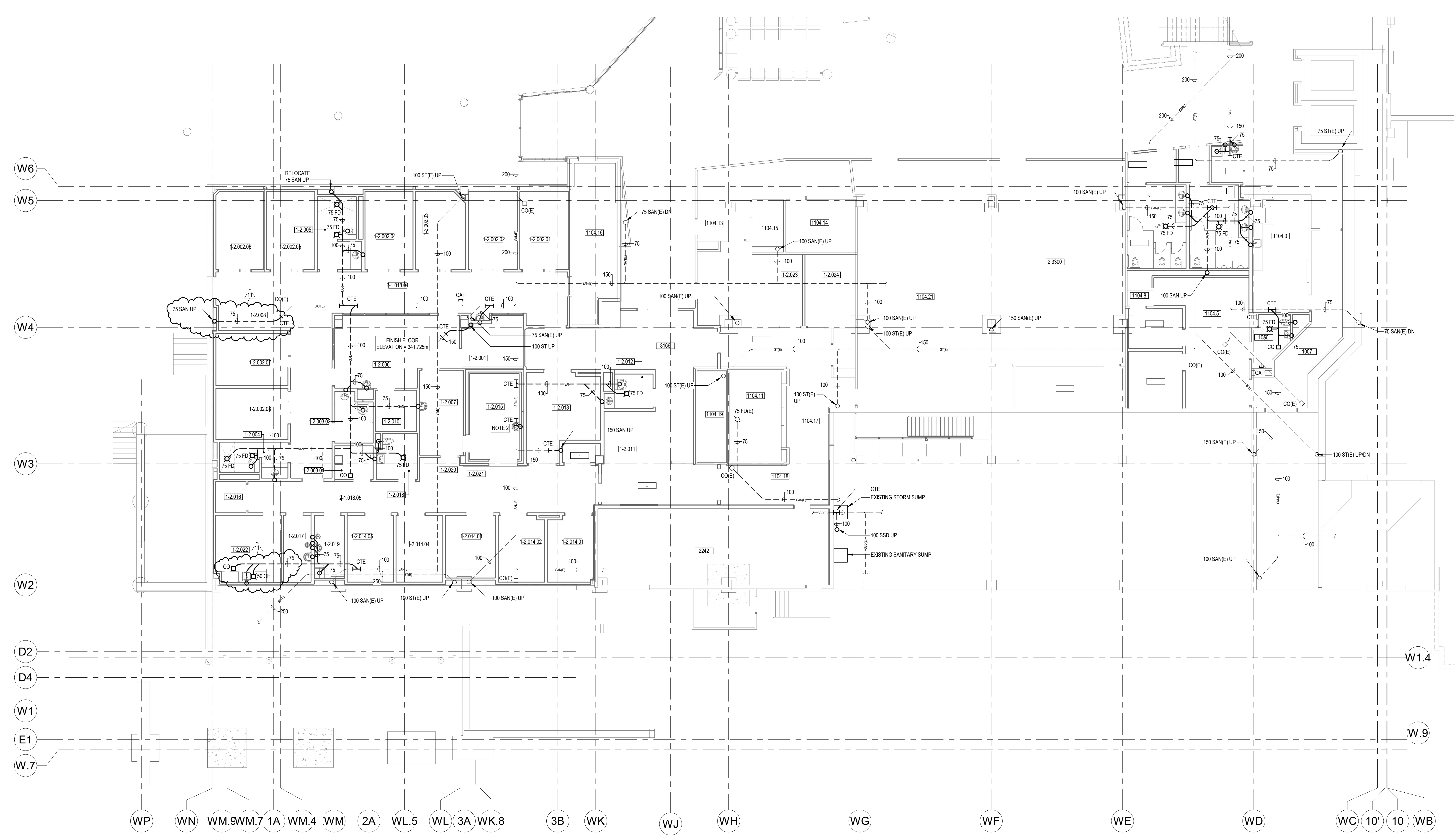
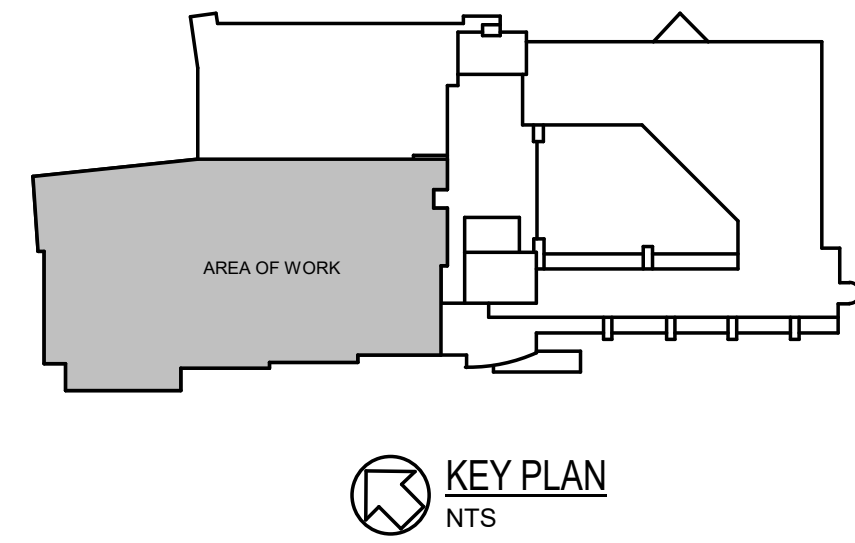

**PHASE 1 - PART LEVEL 1 FLOOR PLAN - BELOW FLOOR DRAINAGE**  
SCALE: 1:100  
NOTES:  
1. MINIMUM BELOW GRADE DRAINAGE PIPING SIZE IS 75mm.  
2. CHIP TOP OF FOOTING AS REQUIRED TO SUIT NEW DRAIN LOCATION.

11	ISSUED FOR ADDENDUM #1	2024.06.14
10	ISSUED FOR TENDER	2024.06.07
9	ISSUED FOR PRE-RENDER	2024.05.27
7	ISSUED FOR BUILDING PERMIT	2024.03.28
6	ISSUED FOR STAGE 1.1 HIGH SUBMISSION	2024.03.23
5	ISSUED FOR COSTING AND GSH REVIEW	2023.12.21
4	ISSUED FOR 42% CONSTRUCTION DOCUMENTS	2023.10.26
3	ISSUED FOR ARCHITECTURE 1.2 SUBMISSION	C48 C48 2023.06.09
2	ISSUED FOR 30% COSTING AND CLIENT REVIEW	C48 C48 2023.03.29
1	ISSUED FOR PRE-SCHEMATIC DESIGN	C48 C48 2023.01.09

Issued/Revision By App'd YYYY.MM.DD

File Name: N/A	EDS	JHE	DRY	2024.06.07
	Dwn	Dgn	Chk'd	YYYY.MM.DD

Permit/Seal



Client/Project  
GUELPH GENERAL HOSPITAL  
EMERGENCY MENTAL HEALTH AND  
ADDICTIONS SERVICES RELOCATION AND  
EMERGENCY DEPARTMENT EXPANSION  
115 DELHI ST, GUELPH, ON, N1E 4J4

Title  
PHASE 1 - PART LEVEL 1 FLOOR PLAN -  
BELOW FLOOR DRAINAGE



Copyright Disclaimer

DO NOT SCALE THE DRAWINGS. ALL MEASUREMENTS ARE TO BE CHECKED AND VERIFIED ON SITE BY THE CONTRACTOR. ANY DISCREPANCIES ARE TO BE REPORTED TO THE CONSULTANT BEFORE PROCEEDING WITH THE WORK.  
COPYRIGHT © ALL RIGHTS RESERVED. DRAWINGS AND RELATED DOCUMENTS ARE THE COPYRIGHT OF THE CONSULTANT AND MUST BE RETURNED UPON REQUEST OR AT THE COMPLETION OF THE WORK. REPRODUCTION OF THESE DRAWINGS OR RELATED DOCUMENTS IN PART OR IN WHOLE BY ELECTRONIC OR MECHANICAL MEANS IS FORBIDDEN BY LAW WITHOUT THE PRIOR WRITTEN PERMISSION OF THE CONSULTANT.

Key Plan



KEY PLAN  
NTS

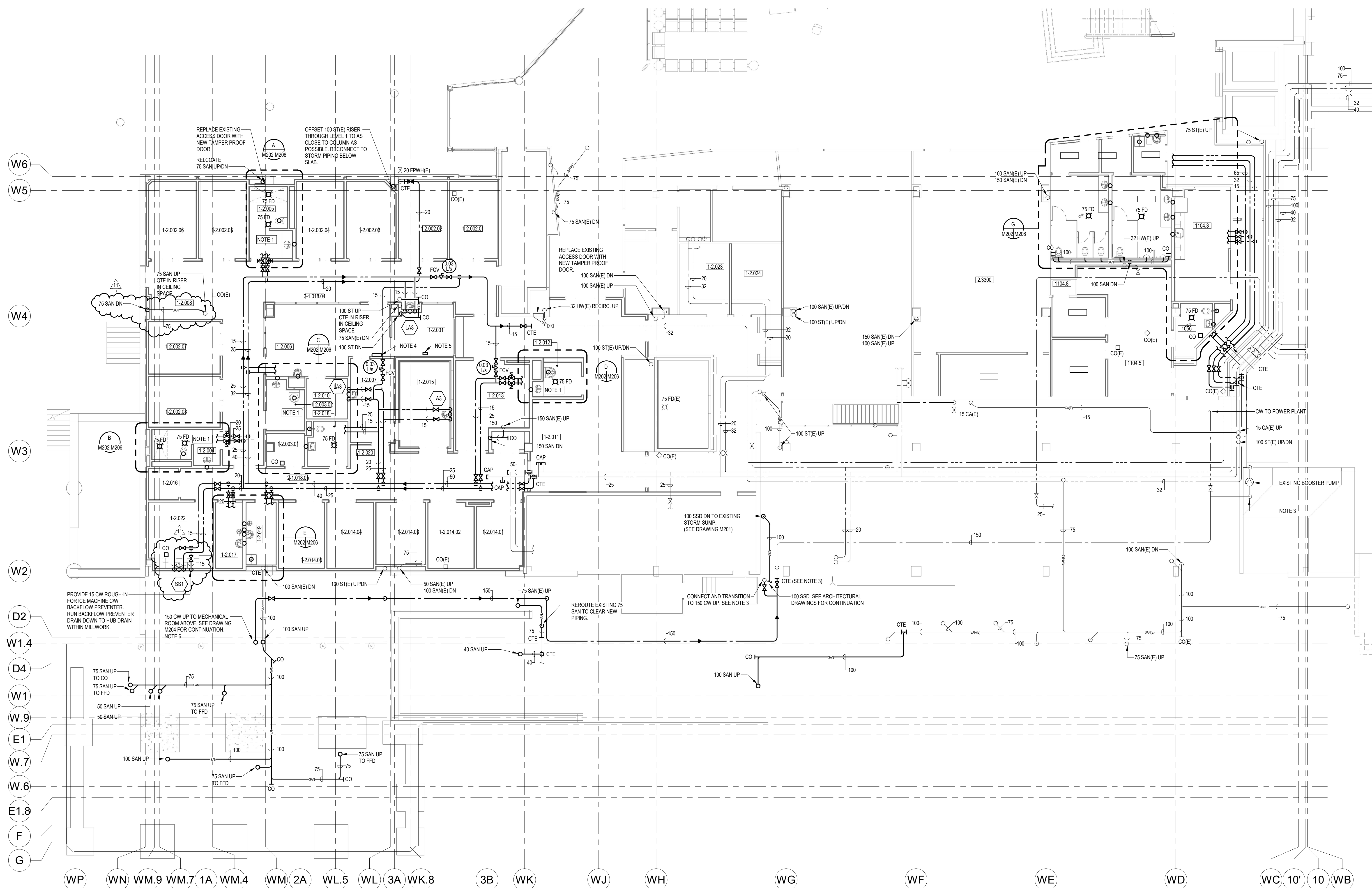

**PHASE 1 - PART LEVEL 1 FLOOR PLAN - PLUMBING**  
SCALE: 1:100

- NOTES:
1. PROVIDE SOLENOID VALVES ON HOT AND COLD WATER SERVING WASHROOM. CONTROLS TO ENABLE WATER FLOW TO BE LOCATED AT NURSES STATION.
  2. MINIMUM BELOW GRADE DRAINAGE PIPING SIZE IS 75mm.
  3. CLOSE ISOLATION VALVES TO ISOLATE DELHI STREET WATER SERVICE FROM THE HOSPITAL DURING SERVICE RELOCATION. PHASE INSTALLATION OF NEW WATER SERVICE TO MINIMIZE THE DURATION THAT THESE VALVES REMAIN CLOSED. IT IS EXPECTED THAT THIS SHUTDOWN WILL BE NO MORE THAN 1 DAY.
  4. EMERGENCY SHUT-OFF SWITCHES TO CONTROL SOLENOID VALVES FOR ROOMS 1-2.003.02, 1-2.004 AND 1-2.005.
  5. EMERGENCY SHUT-OFF SWITCHES TO CONTROL SOLENOID VALVES FOR ROOM 1-2.012.
  6. NEW WATER SERVICE MUST BE INSTALLED STERILIZED AND FULLY OPERATIONAL BEFORE DEMOLITION OF EXISTING WATER SERVICE CAN BE STARTED. REFER TO DEMOLITION DRAWINGS FOR FURTHER PHASING NOTES.

Issued/Revision	By	App'd	YYYY.MM.DD
11	ISSUED FOR ADDENDUM #1		2024.06.14
10	ISSUED FOR TENDER		2024.06.07
9	ISSUED FOR PRE-TENDER		2024.05.27
7	ISSUED FOR BUILDING PERMIT		2024.03.28
6	ISSUED FOR STAGE 3.1 HIGH SUBMISSION		2024.03.23
5	ISSUED FOR COSTING AND GSH REVIEW		2023.12.21
4	ISSUED FOR 42% CONSTRUCTION DOCUMENTS	C48	2023.10.26
3	ISSUED FOR 40% SERVICE 2.3 SUBMISSION	C48	2023.06.09
2	ISSUED FOR 30% COSTING AND CLIENT REVIEW	C48	2023.03.29
1	ISSUED FOR 10% SCHEMATIC DESIGN	C48	2023.11.09

File Name: N/A EDS JHE DBV 2024.06.07  
Dwn Dgn Ckch YYYY.MM.DD

Permit/Seal



Client/Project Logo  
Client/Project  
GUELPH GENERAL HOSPITAL  
EMERGENCY MENTAL HEALTH AND ADDICTIONS SERVICES RELOCATION AND EMERGENCY DEPARTMENT EXPANSION  
115 DELHI ST. GUELPH, ON, N1E 4J4

Title  
PHASE 1 - PART LEVEL 1 FLOOR PLAN - PLUMBING

Project No. 9609 Scale 1:100  
Revision Drawing No. M202  
11







Copyright Disclaimer

DO NOT SCALE THE DRAWINGS. ALL MEASUREMENTS ARE TO BE CHECKED AND VERIFIED ON SITE BY THE CONTRACTOR. ANY DISCREPANCIES ARE TO BE REPORTED TO THE CONSULTANT BEFORE PROCEEDING WITH THE WORK.  
COPYRIGHT © ALL RIGHTS RESERVED. DRAWINGS AND RELATED DOCUMENTS ARE THE COPYRIGHT OF THE CONSULTANT AND MUST BE RETURNED UPON REQUEST OR AT THE COMPLETION OF THE WORK. REPRODUCTION OF THESE DRAWINGS OR RELATED DOCUMENTS IN PART OR IN WHOLE BY ELECTRONIC OR MECHANICAL MEANS IS FORBIDDEN BY LAW WITHOUT THE PRIOR WRITTEN PERMISSION OF THE CONSULTANT.

Key Plan

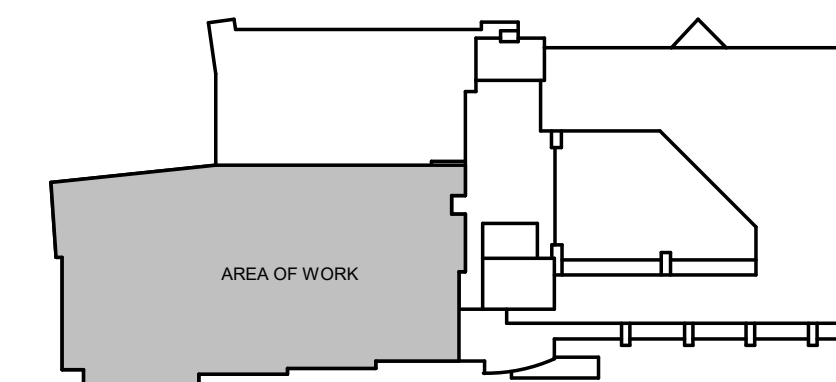

KEY PLAN  
NTS

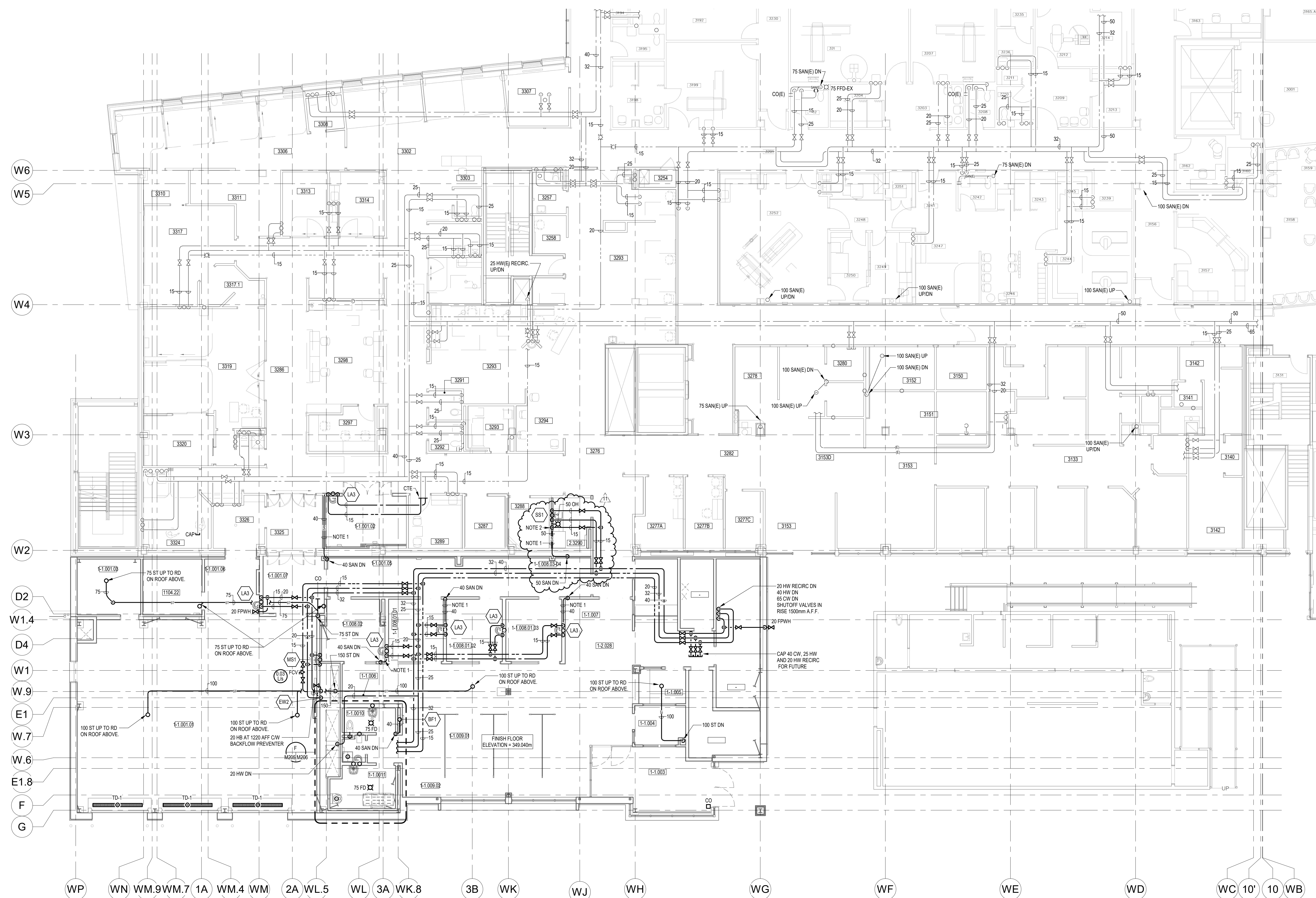

PHASE 1 - PART LEVEL 3 FLOOR PLAN - PLUMBING

SCALE: 1:100

NOTES:

- SANITARY PIPING TO RUN HORIZONTALLY THROUGH WALL TO AVOID ANY NEW PIPING RUNNING THROUGH ROOM 2236 ON LEVEL 2 BELOW.
- PROVIDE 15 CW ROUGH-IN FOR ICE MACHINE CW BACKFLOW PREVENTER. RUN BACKFLOW PREVENTER DRAIN DOWN TO HUB DRAIN WITHIN MILLWORK.

11	ISSUED FOR ADDENDUM #1	2024.06.14
10	ISSUED FOR TENDER	2024.06.07
9	ISSUED FOR PRE-RENDER	2024.05.27
7	ISSUED FOR BUILDING PERMIT	2024.03.28
6	ISSUED FOR STAGE 2.1 SUBMISSION	2024.03.23
5	ISSUED FOR COSTING AND GSH REVIEW	2023.12.21
4	ISSUED FOR 20% CONSTRUCTION DOCUMENTS	2023.10.26
3	ISSUED FOR 10% SUBMISSION	2023.09.09
2	ISSUED FOR 30% COSTING AND CLIENT REVIEW	C48 C48 2023.03.29
1	ISSUED FOR 10% SCHEMATIC DESIGN	C48 C48 2023.01.09

Issued/Revision By App'd YYYY.MM.DD

File Name: N/A EDS JHE DBV 2024.06.07  
Dwn Dgn Chk'd YYYY.MM.DD

Permit/Seal



Client/Project  
GUELPH GENERAL HOSPITAL  
EMERGENCY MENTAL HEALTH AND ADDICTIONS SERVICES RELOCATION AND EMERGENCY DEPARTMENT EXPANSION  
115 DELHI ST, GUELPH, ON, N1E 4J4

Title  
PHASE 1 - PART LEVEL 3 FLOOR PLAN - PLUMBING

Project No. 9609 Scale 1:100  
Revision Drawing No. M205  
11