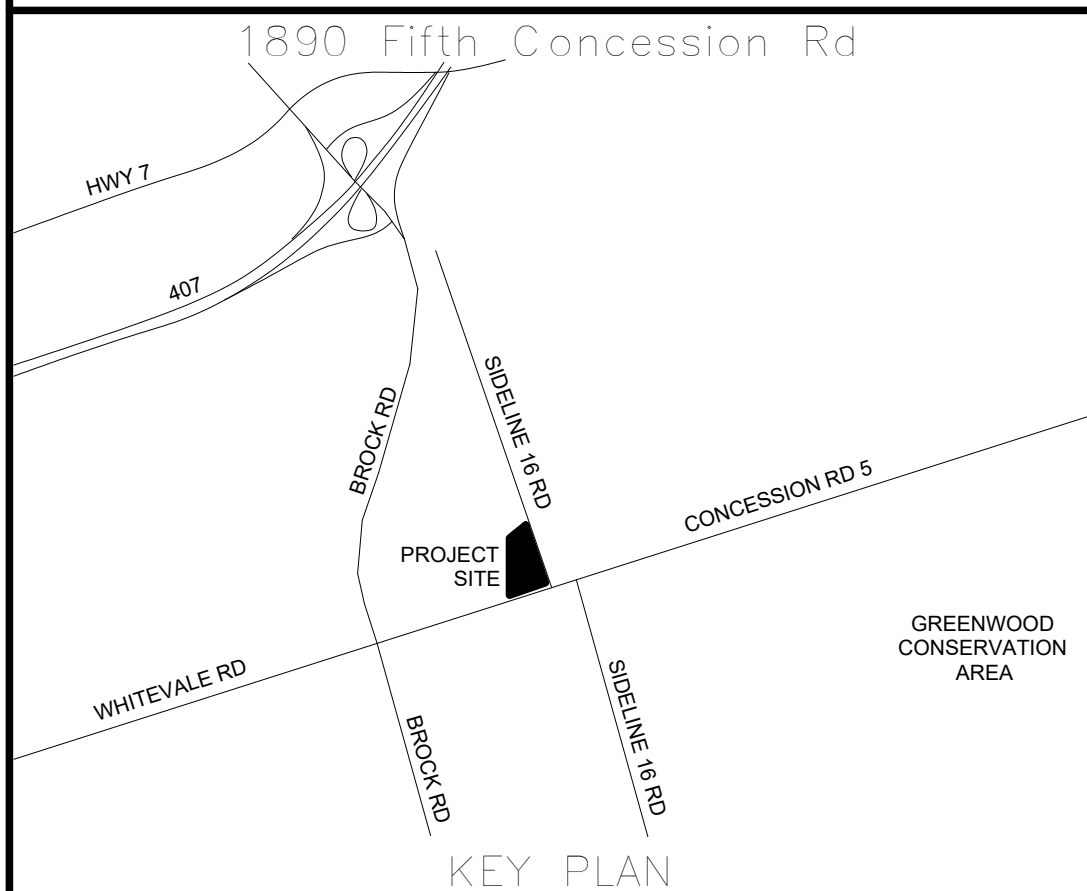

SIDELINE 16 ROAD

1. PRIOR TO COMMENCEMENT OF ANY ON-SITE WORK/TOPSOIL STRIPPING, EROSION AND SEDIMENT CONTROL (ESC) MEASURES, AS PER APPROVED EROSION & SEDIMENT CONTROL PLAN, MUST BE INSTALLED TO PREVENT SURFACE RUNOFF FROM LEAVING THE SITE "UNTREATED". ALL ESC MEASURES ARE TO BE MAINTAINED UNTIL THE SITE HAS BEEN STABILIZED.
2. THE CONTRACTOR SHALL BE RESPONSIBLE FOR THE PROPER INSTALLATION, MAINTENANCE AND REMOVAL OF ALL TEMPORARY EROSION AND SEDIMENT CONTROL MEASURES DURING CONSTRUCTION, AS DIRECTED BY THE ENGINEER OR THE CITY OF PICKERING.
3. SEDIMENT CONTROL FENCE TO USE GEOTEXTILE WITH WEAVE DENSITY OF 270R TERRYFAX OR EQUIVALENT.
4. EXPOSED SOILS SHALL BE IMMEDIATELY STABILIZED AS DIRECTED BY THE ENGINEER OR CITY OF PICKERING.
5. ROAD DUSTS ARE TO BE MINIMIZED IN ANY TEMPORARY TRAVEL AREAS REQUIRED DURING CONSTRUCTION PERIOD.
6. ADDITIONAL EROSION AND SEDIMENT CONTROL MEASURES MAY BE REQUIRED AND SHALL BE DETERMINED BY THE ENGINEER OR THE CITY OF PICKERING.
7. ALL SWALES ARE TO BE STABILIZED PRIOR TO USE.
8. IN THE EVENT OF THE PROPOSED EROSION AND SEDIMENT CONTROL MEASURES WILL OCCUR ON A WEEKLY BASIS, AFTER RAINFALL EVENTS EXCEEDING 10mm OR AFTER RAPID SNOW MELT EVENTS AND DAILY DURING EXTENDED RAIN OR SNOW MELT PERIODS, THE SILT CONTROL FENCE MUST BE INSPECTED FOR RIPS OR TEARS, BROKEN STAKES, BLOW OUTS AND ACCUMULATION OF SEDIMENT. THE SILT CONTROL FENCE MUST BE FIXED AND/OR REPLACED IMMEDIATELY WHEN DAMAGED.
9. ACCUMULATED SEDIMENT MUST BE REMOVED FROM THE SILT CONTROL FENCE WHEN ACCUMULATION REACHES 50% OF THE HEIGHT OF THE FENCE.
10. ROAD DAMS ARE TO BE CLEANED OF ALL ACCUMULATED SEDIMENT AS SOON AS SEDIMENT HAS ACCUMULATED TO A DEPTH GREATER THAN 50% OF ALL THE UPSTREAM CHECK DAMS.
11. CLEANING AND REPAIR OF MUD MATS AND ANY OTHER TEMPORARY SEDIMENT CONTROL MEASURES SHALL BE DONE AS NECESSARY THROUGH REGULAR INSPECTION OR AS DIRECTED BY THE ENGINEER OR CITY OF PICKERING. ALL DAMAGED ESC MEASURES SHALL BE REPAIRED AND/OR REPLACED WITHIN 48 HOURS OF THE INSPECTION.
12. MATERIALS TO REPAIR DAMAGED ESC MEASURES MUST BE KEPT ON-SITE AT ALL TIMES.
13. THE ESC STRATEGIES ON THESE PLANS ARE NOT STATIC AND MAY NEED TO BE UPGRADED/AMENDED AS SITE CONDITIONS CHANGE TO PREVENT SEDIMENT RELEASES. FAILED ESC MEASURE MUST BE REPAIRED IMMEDIATELY.
14. ALL CONSTRUCTION ACTIVITIES SHALL BE STOPPED WHEN THE SILT CONTROL FENCE OR LIMIT OR DEVELOPMENT. ALL CONSTRUCTION VEHICLES SHALL LEAVE THE SITE AT DESIGNATED LOCATIONS AS SHOWN ON THE PLANS. ALL MATERIALS AND EQUIPMENT SHALL BE STORED ON SITE IN A DESIGNATED AREA. NO MATERIALS OR EQUIPMENT SHALL BE STORED ON THE MUNICIPAL RIGHT OF WAY. NO CONSTRUCTION VEHICLES WILL PARK ON MUNICIPAL ROADS.
15. DURING CONSTRUCTION OF THE PROJECT, THE SITE IS PROHIBITED FROM BEING USED FOR ANY OTHER PURPOSES.
16. THE CONTRACTOR MUST CLEAN ADJACENT ROADS ON A REGULAR BASIS. THE ROAD SHALL BE, AT A MINIMUM SCARPED DAILY AND FLUSHED (IF NECESSARY) ON FRIDAY EVENINGS OR SATURDAY MORNINGS.
17. DUST CONTROL TO BE REVIEWED DAILY. WATER TRUCK OR CALCIUM CHLORIDE IS TO BE PROVIDED ON-SITE AND HAUL ROADS/WORKING AREAS ARE TO BE TREATED AS REQUIRED TO ENSURE THAT DUST IS CONTROLLED ON-SITE.
18. THE END OF CONSTRUCTION OF THE PROJECT, ACCUMULATED SEDIMENT IS TO BE REMOVED OFF SITE PRIOR TO THE REMOVAL OF THE SILT FENCE.
19. ALL LITTER AND DEBRIS SHALL BE MONITORED AND DISPOSED OF DAILY OR AS NECESSARY THROUGH REGULAR INSPECTION.
20. ALL TOPSOIL STOCKPILES SHALL BE SURROUNDED WITH SEDIMENT CONTROL FENCE AND STABILIZED WITH SEED MIX AS PER THIS DRAWING.
21. ALL EROSION AND SEDIMENT CONTROL MEASURES ARE TO BE MINIMIZED TO THE EXTENT POSSIBLE AND STABILIZED AS THE WORK PROGRESSES. ANY AREA EXPOSED FOR MORE THAN 30 DAYS WILL BE STABILIZED.

	PROPOSED SILT FENCE
	PROPOSED STAGING LIMIT
	PROPOSED MUDMAT
	EXISTING WETLAND BOUNDARY
	EXISTING WETLAND SETBACK
	EXISTING PROPERTY LINE
	EXISTING BOREHOLE
	EXISTING UNDERGROUND GAS
	EXISTING OVERHEAD HYDRO
	EXISTING FENCE
	EXISTING MAJOR CONTOUR
	EXISTING MINOR CONTOUR
	EXISTING HYDRO POLE
	EXISTING DITCH LINE
	EXISTING EDGE OF PAVEMENT
	OVERLAND FLOW

ALL MEASUREMENTS ARE TO BE VERIFIED BY THE CONTRACTOR ON SITE AND ANY DISCREPANCIES ARE TO BE REPORTED BEFORE PROCEEDING WITH THE WORK. THE REGION OF DURHAM ASSUMES NO RESPONSIBILITY FOR THE ACCURACY OF THE LOCATION OF EXISTING SERVICES AS INDICATED ON THIS DRAWING. DO NOT SCALE DRAWINGS.

[illegible]**AECOM**

SURVEY COMPLETED BY IBW SURVEYORS JULY 2018

ALL ELEVATIONS ARE IN METERS. DISTANCES ARE GROUND AND CAN BE CONVERTED TO GRID BY MULTIPLYING BY THE COMBINED SCALE FACTOR OF 0.99986.

ELEVATIONS ARE GEODETIC AND REFERRED TO CITY OF PICKING BENCHMARK 4-031 AND HAVING A GEODETIC ELEVATION OF 151.957m.

DESIGN BY: SM	SCALE: 1:500
DRAWN BY: MB	DATE: 22 September, 2021
CHECKED BY: SM	CONSULTANT PROJECT NO. 60698928
APPROVED BY: -	CLIENT FILE No.: 811/20

1.	09/22/21	JC	ISSUED FOR TENDER
NO.	DATE.	NAME	REVISIONS

NEW SEATON PARAMEDIC STATION
AND TRAINING FACILITY IN PICKERING
EROSION & SEDIMENT CONTROL
CONSTRUCTION MANAGEMENT PLAN

PROPERTY NO.	FACILITIES CODE	FACILITIES PROJECT NO. P061-18-01
CONTRACT NO. T-1160-2021	DRAWING NO. C-101	SHEET NO.

PROPERTY NO.	FACILITIES CODE	FACILITIES PROJECT NO. P061-18-01
CONTRACT NO. T-1160-2021	DRAWING NO. C-102	SHEET NO.

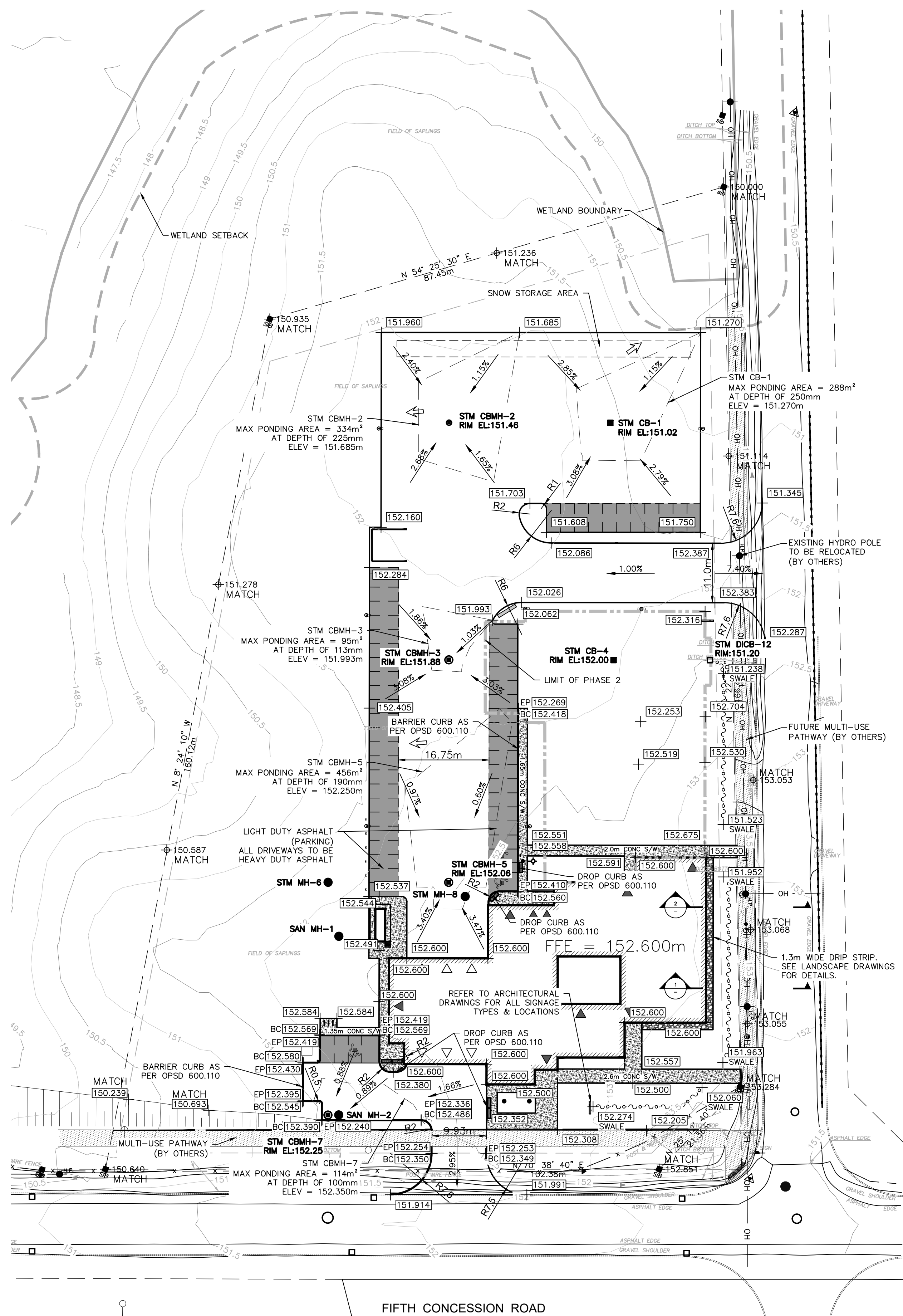
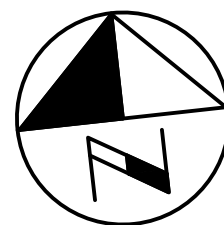

PHASE 1
GRADING

SIDELINE 16 ROAD

FIFTH CONCESSION ROAD

LEGEND

	PROPOSED SPOT ELEVATION
	EXISTING SPOT ELEVATION
	SURFACE FLOW ARROW
	OVERLAND FLOW
	PROPOSED STAGING LIMIT
	PROPOSED PONDING AREA
	PROPOSED SWALE
	EXISTING WETLAND BOUNDARY
	EXISTING WETLAND SETBACK
	EXISTING PROPERTY LINE
	PROPERTY LINE SETBACK
	EXISTING BOREHOLE
	EXISTING UNDERGROUND GAS
	EXISTING OVERHEAD HYDRO
	EXISTING FENCE
	EXISTING MAJOR CONTOUR
	EXISTING MINOR CONTOUR
	EXISTING HYDRO POLE
	EXISTING DITCH LINE
	EXISTING EDGE OF PAVEMENT

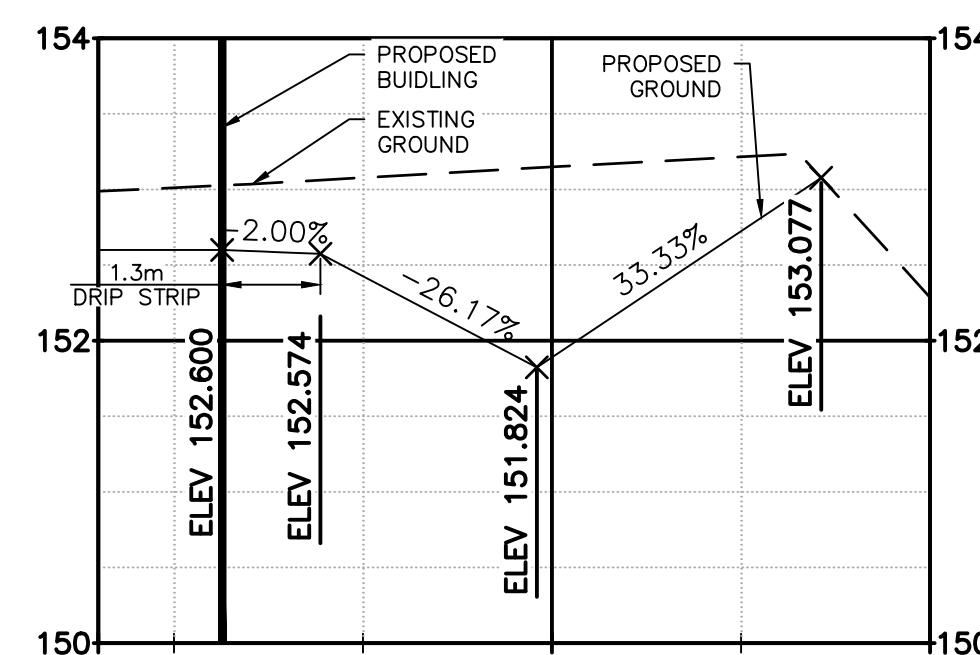

SECTION 1

H: 1:100
V: 1:50

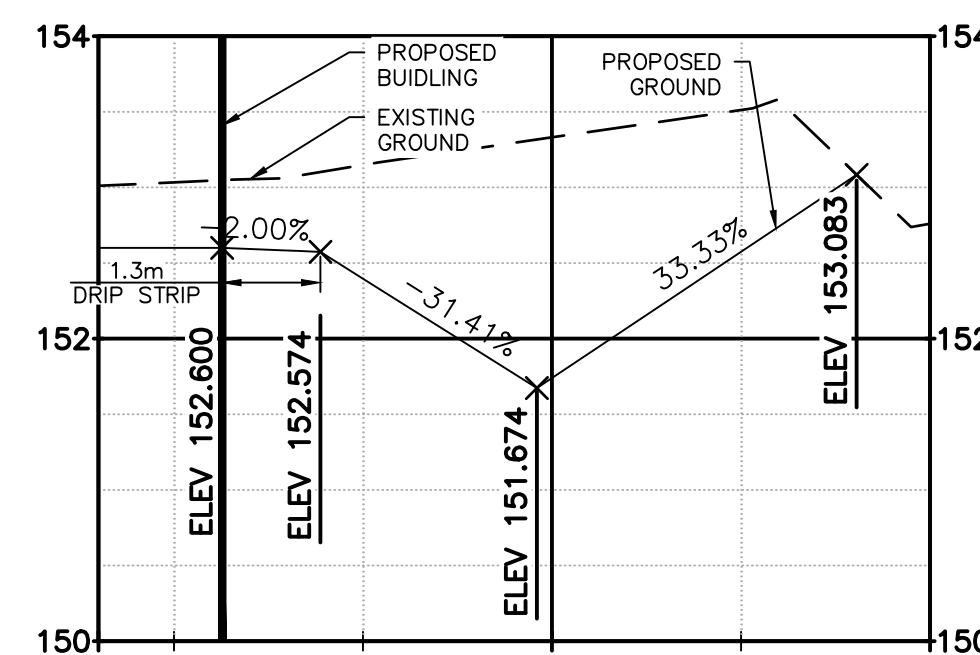

SECTION 2

H: 1:100
V: 1:50

ALL MEASUREMENTS ARE TO BE VERIFIED BY THE CONTRACTOR ON SITE AND ANY DISCREPANCIES ARE TO BE REPORTED BEFORE PROCEEDING WITH THE WORK. THE REGION OF DURHAM ASSUMES NO RESPONSIBILITY FOR THE ACCURACY OF THE LOCATION OF EXISTING SERVICES AS INDICATED ON THIS DRAWING. DO NOT SCALE DRAWINGS.

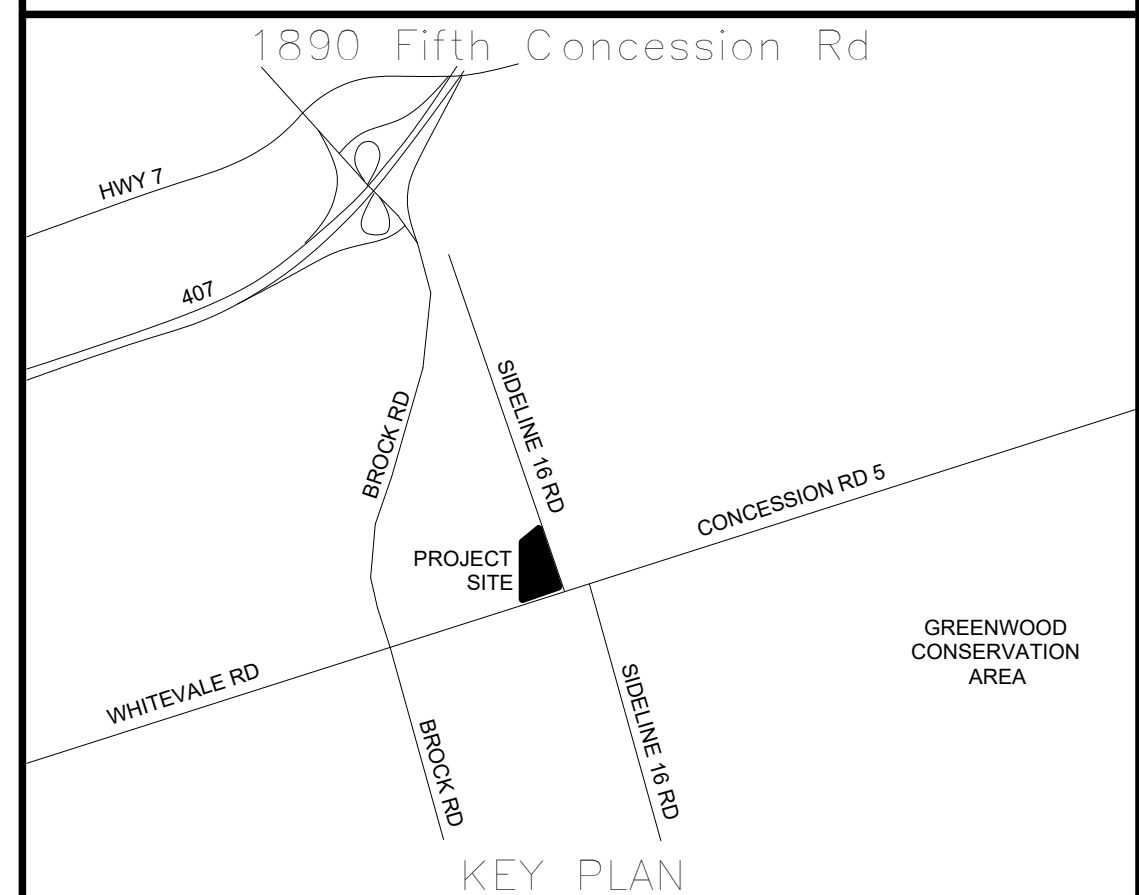

NO.	DATE	NAME	REVISIONS

PRIME CONSULTANT

AECOM

AECOM Canada Ltd.
50 Sportsworld Crossing Road, Suite 290
Kitchener, Ontario, N2P 0A4
519 650 5313 tel 519 650 3424 fax
www.aecom.com

CONSULTANT RESPONSIBILITIES

2021/09/20

PROVINCE OF ONTARIO

SURVEY & BENCHMARK
SURVEY COMPLETED BY IBW SURVEYORS JULY 2018.
ALL ELEVATIONS ARE IN METERS. DISTANCES ARE GROUND AND CAN BE CONVERTED TO GRID BY MULTIPLYING BY THE COMBINED SCALE FACTOR OF 0.99986.
ELEVATIONS ARE GEODETIC AND REFERRED TO CITY OF PICKERING BENCHMARK 4-031 AND HAVING A GEODETIC ELEVATION OF 151.957m.

DESIGN BY: SM	SCALE: 1:500
DRAWN BY: MB	DATE: 22 September, 2021
CHECKED BY: SM	CONSULTANT PROJECT NO. 60698928
APPROVED BY: -	CLIENT FILE No.: 811/20

NO.	DATE	NAME	REVISIONS
1	09/22/21	JC	ISSUED FOR TENDER

THE REGIONAL MUNICIPALITY OF DURHAM

WORKS DEPARTMENT
DESIGN, CONSTRUCTION & ASSET MANAGEMENT

NEW SEATON PARAMEDIC STATION AND TRAINING FACILITY IN PICKERING SITE GRADING PLAN

PROPERTY NO.	FACILITIES CODE	FACILITIES PROJECT NO.
CONTRACT NO.	DRAWING NO.	SHEET NO.
T-1160-2021	C-103	P061-18-01

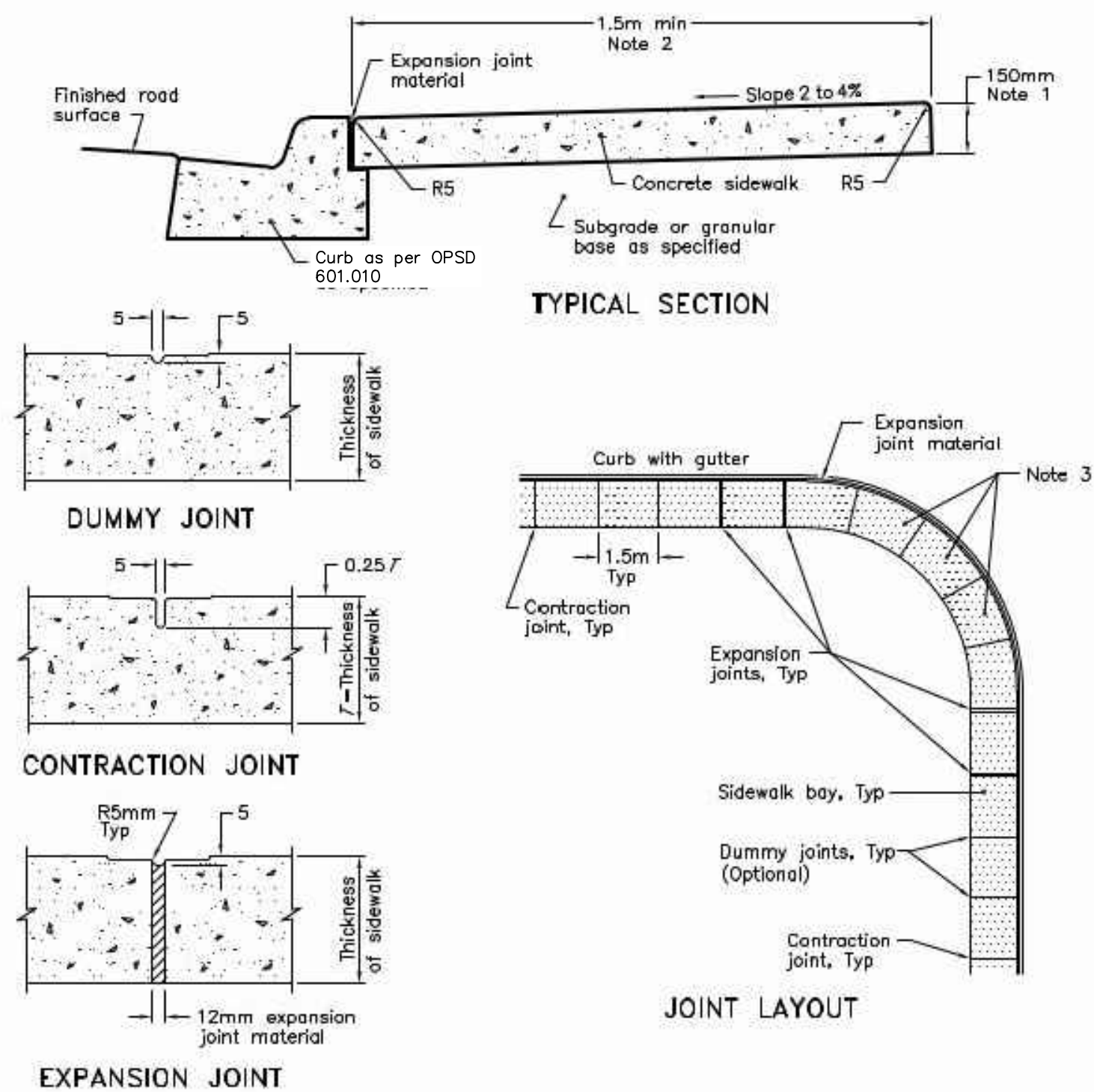

- NOTES:**
- At commercial and industrial driveways, the thickness shall be 200mm.
 - Sidewalk width shall be wider when specified.
 - This OPSD shall be read in conjunction with OPSD 310.030, 310.031, 310.033, and 310.039.
- A All dimensions are in millimetres unless otherwise shown.

DETAIL MONOLITHIC SIDEWALK

NOT TO SCALE

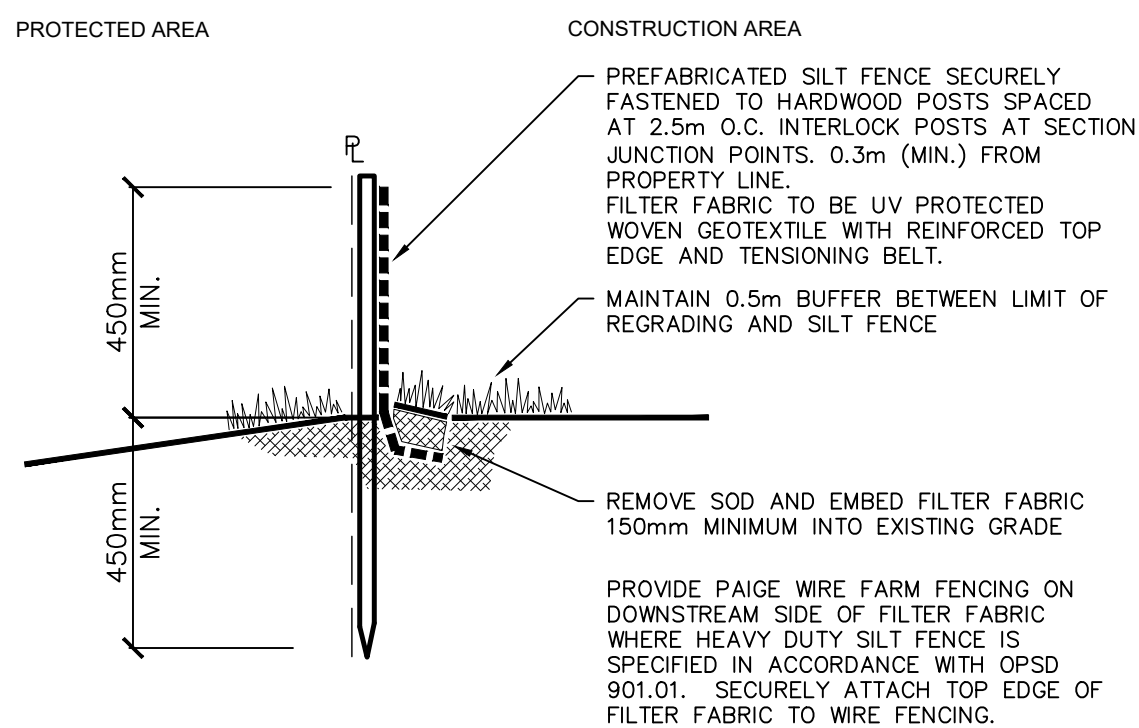

CONSTRUCTION DEWATERING NOTES

PRIOR TO COMMENCEMENT OF CONSTRUCTION DEWATERING ACTIVITIES, AREAS REQUIRING DEWATERING (GROUNDWATER AND/OR SURFACE WATER) MAY BE EVALUATED THROUGH A CONSTRUCTION DEWATERING ASSESSMENT. WHERE REQUIRED, PERMITS AND APPROVALS FOR WATER TAKING AND DISCHARGE SHALL BE OBTAINED, AND MONITORING REQUIREMENTS WILL BE INCORPORATED INTO SITE-SPECIFIC MONITORING PROCEDURES.

DURING THE CONSTRUCTION PHASE OF THE PROJECT THE CONTRACTOR MUST ADHERE TO THE CONDITIONS OF ANY APPLICABLE WATER TAKING OR DISCHARGE PERMIT OBTAINED FOR THE PROJECT AND ENSURE THAT DEWATERING EFFLUENT MEETS THE APPLICABLE WATER QUALITY CRITERIA. THE FOLLOWING BEST MANAGEMENT PRACTICES ARE ALSO RECOMMENDED:

- WHERE REQUIRED USE TEMPORARY STORAGE TANKS FOR THE CONTAINMENT OF DEWATERING EFFLUENT PRIOR TO THE COLLECTION AND ANALYSIS OF WATER QUALITY SAMPLES;
- WHERE REQUIRED, USE TEMPORARY STORAGE TANKS OR SEDIMENT TRAPS TO FACILITATE THE SETTLING AND REMOVAL OF FINE SEDIMENT FROM DEWATERING EFFLUENT TO MEET APPLICABLE TSS DISCHARGE REQUIREMENTS;
- WHERE DEWATERING EFFLUENT IS DISCHARGED TO THE VEGETATED OR STABILIZED SURFACES, ENSURE THAT DEWATERING EFFLUENT IS RELEASED IN A CONTROLLED MANNER THAT PROMOTES RE-INFILTRATION TO THE OVERBURDEN AND PREVENTS POTENTIAL OVERLAND FLOW AND SUBSEQUENT DISCHARGE TO ADJACENT SURFACE WATER FEATURES;
- WHERE DEWATERING EFFLUENT IS DISCHARGED TO SURFACE WATER, ENSURE THAT APPROPRIATE CONTROLS ARE INSTALLED AT DISCHARGE LOCATIONS TO PREVENT EROSION AND SEDIMENTATION OF RECEIVERS AND APPROPRIATE ENERGY DISSIPATION AND SETTLING/FILTRATION MEASURES ARE INSTALLED TO ENSURE THAT EROSION/SEDIMENT RELEASE TO WATERCOURSES/DRAINAGE FEATURES IS MITIGATED; AND;
- WHERE DEWATERING EFFLUENT DOES NOT MEET APPLICABLE SURFACE WATER OR GROUNDWATER CRITERIA, IT MAY BE MANAGED AS LIQUID INDUSTRIAL WASTE (LIW) AND TRANSPORTED TO A LICENSED OFF-SITE DISPOSAL FACILITY FOR TREATMENT.

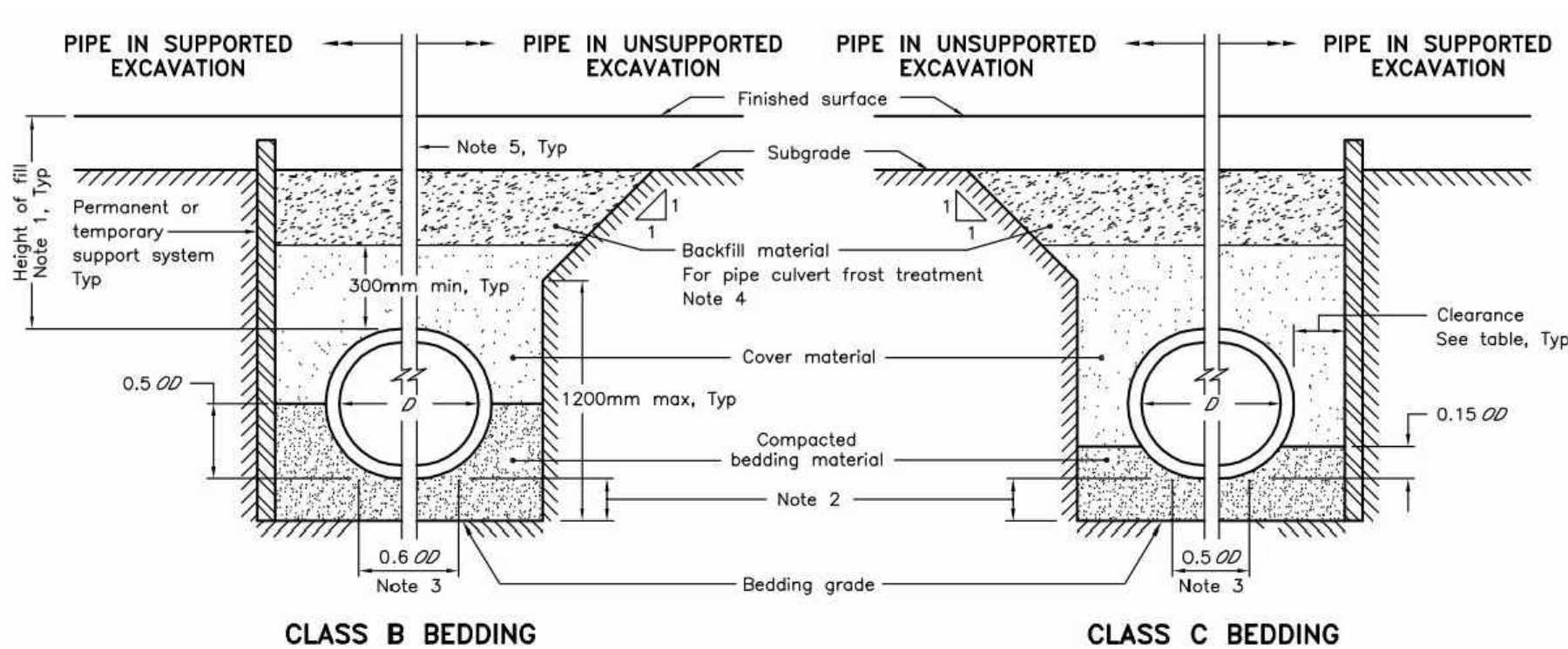

NOTES:

- Height of fill is measured from the finished surface to top of pipe.
- The minimum bedding depth below the pipe shall be 0.15D in no case shall this dimension be less than 150mm or greater than 300mm.
- The pipe bed shall be compacted and shaped to receive the bottom of the pipe.
- Pipe culvert frost treatment shall be according to OPSD 803.030 and 803.031.
- Condition of excavation is symmetrical about centreline of pipe.

A Soil types as defined in the Occupational Health and Safety Act and Regulations for Construction Projects.

B All dimensions are in metres unless otherwise shown.

LEGEND:

D – Inside diameter

OD – Outside diameter

Pipe Inside Diameter mm	Clearance mm
900 or less	300
Over 900	500

DETAIL PIPE BACKFILL

NOT TO SCALE

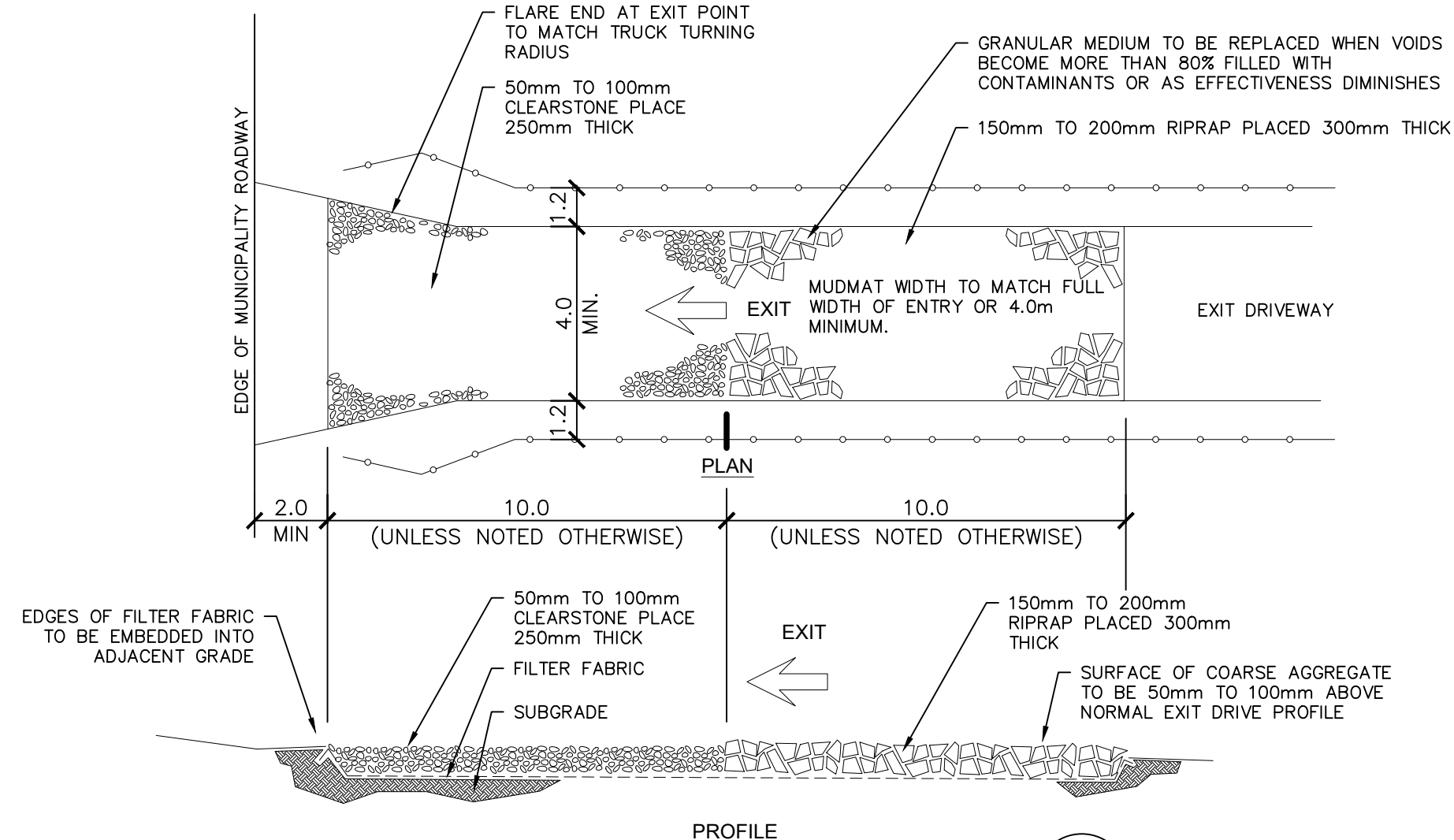

DETAIL EXIT MUDMAT

NOT TO SCALE

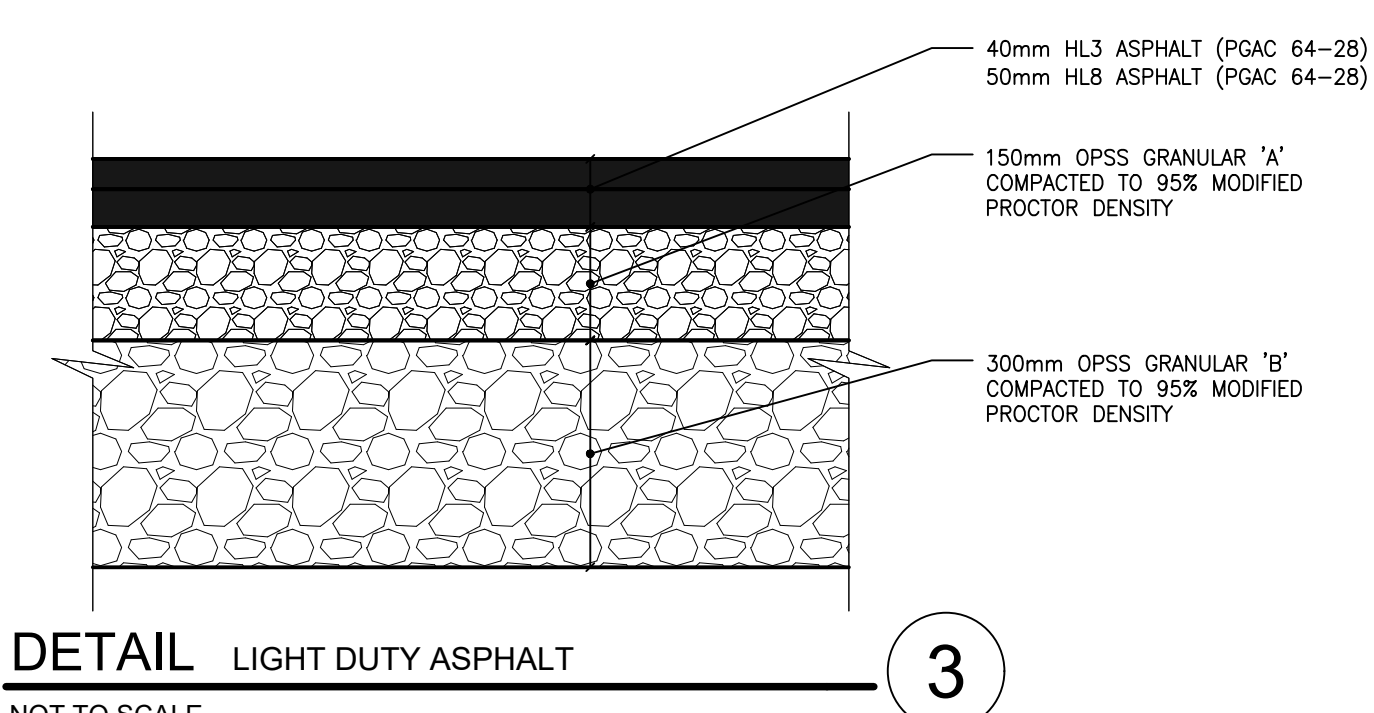

DETAIL LIGHT DUTY ASPHALT

NOT TO SCALE

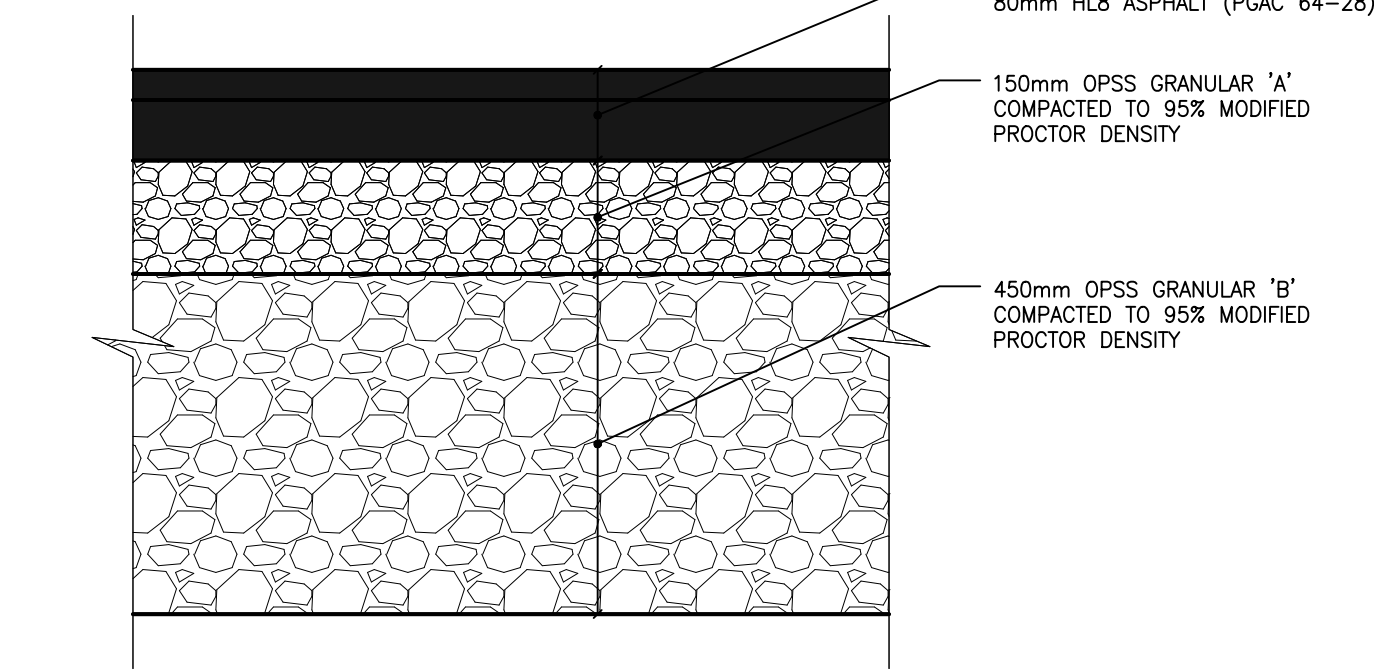

DETAIL HEAVY DUTY ASPHALT

NOT TO SCALE

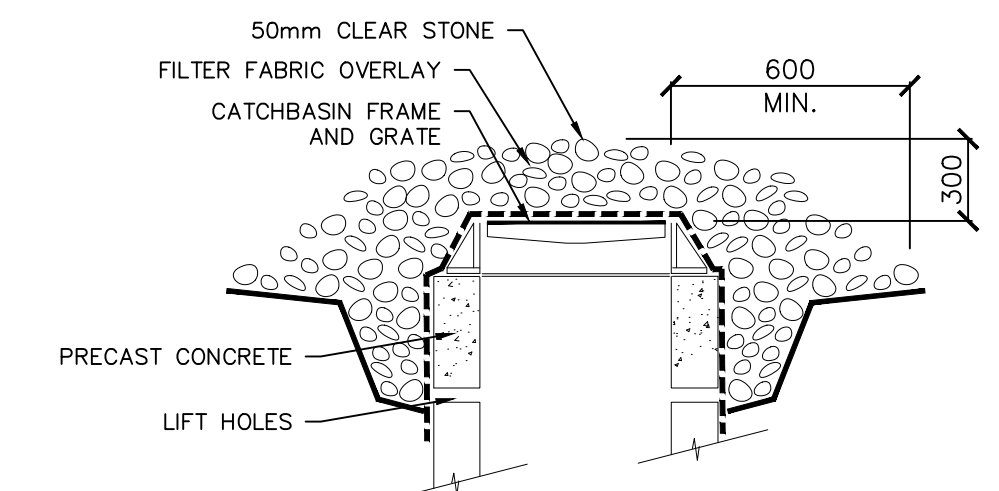

DETAIL CATCHBASIN TREATMENT

NOT TO SCALE

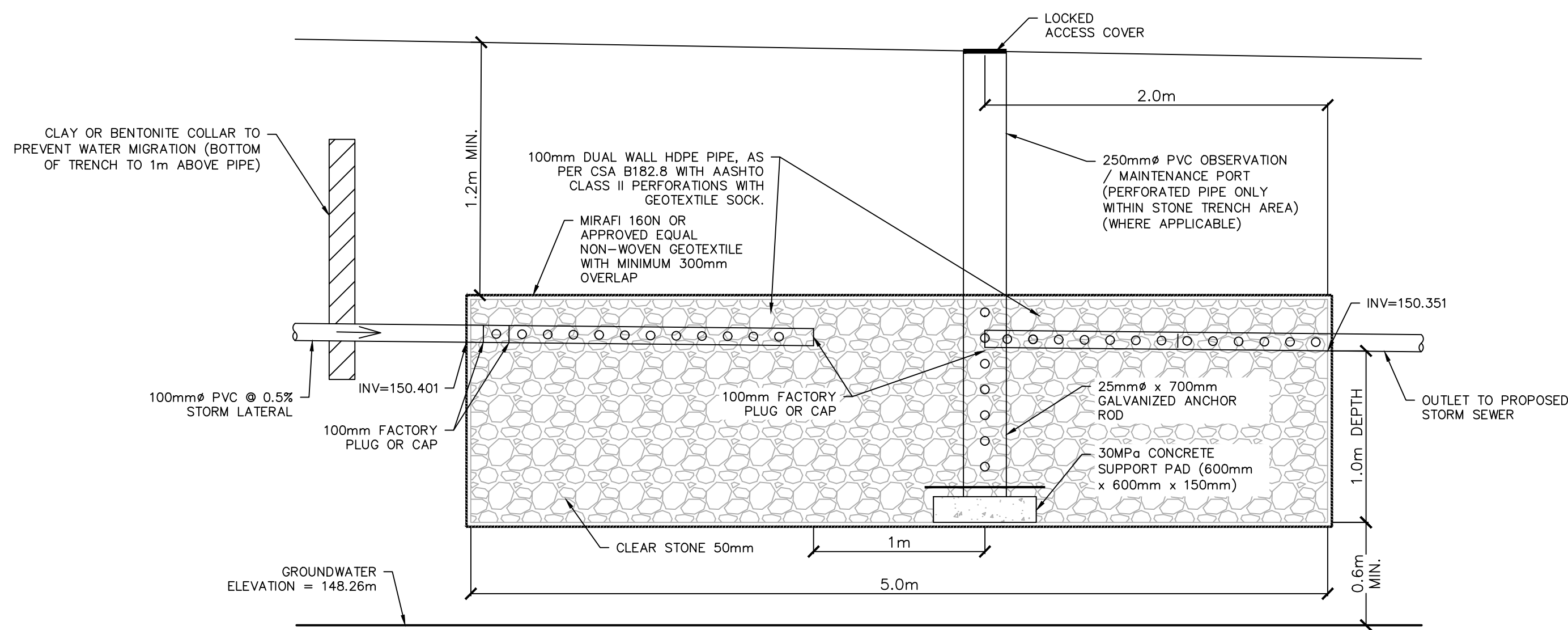

DETAIL INFILTRATION GALLERY

NOT TO SCALE

ALL MEASUREMENTS ARE TO BE VERIFIED BY THE CONTRACTOR ON SITE AND ANY DISCREPANCIES ARE TO BE REPORTED BEFORE PROCEEDING WITH THE WORK. THE REGION OF DURHAM ASSUMES NO RESPONSIBILITY FOR THE ACCURACY OF THE LOCATION OF EXISTING SERVICES AS INDICATED ON THIS DRAWING. DO NOT SCALE DRAWINGS.

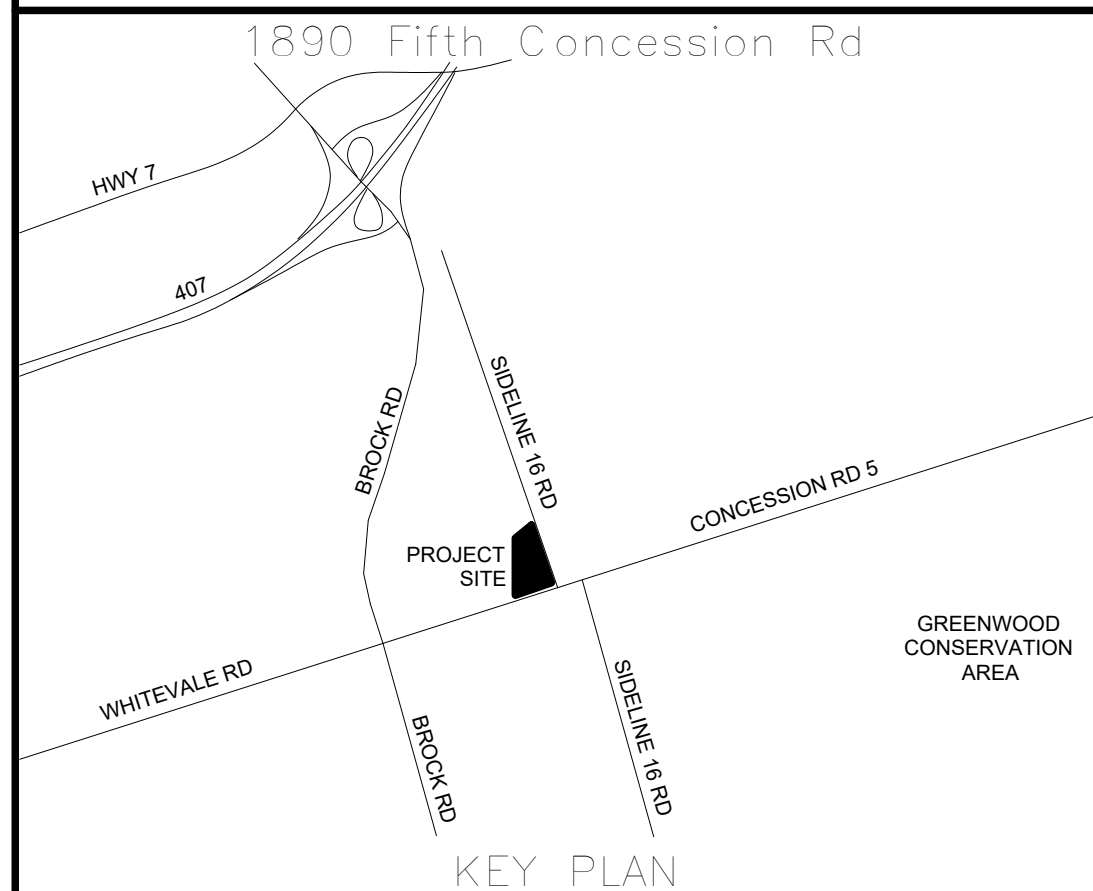

NO.	DATE	NAME	REVISIONS

AECOM

AECOM Canada Ltd.
50 Sportsworld Crossing Road, Suite 290
Kitchener, Ontario, N2P 0A4
519 650 5313 tel 519 650 3424 fax
www.aecom.com

PROFESSIONAL ENGINEER
S.T. MATROU
100147402
2023/09/20
PROVINCE OF ONTARIO

SURVEY & BENCHMARK

SURVEY COMPLETED BY IBW SURVEYORS JULY 2018.

ALL ELEVATIONS ARE IN METERS. DISTANCES ARE GROUND AND CAN BE CONVERTED TO GRID BY MULTIPLYING BY THE COMBINED SCALE FACTOR OF 0.99986.

ELEVATIONS ARE GEODETIC AND REFERRED TO CITY OF PICKERING BENCHMARK 4-031 AND HAVING A GEODETIC ELEVATION OF 151.957m.

DESIGN BY: SM	SCALE: AS NOTED
DRAWN BY: MB	DATE: 22 September, 2021
CHECKED BY: SM	CONSULTANT PROJECT NO. 60698928
APPROVED BY: -	CLIENT FILE No.: 811/20

NO.	DATE	NAME	REVISIONS

DURHAM REGION

THE REGIONAL MUNICIPALITY OF DURHAM

WORKS DEPARTMENT

DESIGN, CONSTRUCTION & ASSET MANAGEMENT

NEW SEATON PARAMEDIC STATION AND TRAINING FACILITY IN PICKERING DETAILS

PROPERTY NO.	FACILITIES CODE	FACILITIES PROJECT NO. P061-18-01
CONTRACT NO. T-1160-2021	DRAWING NO. C-104	SHEET NO.

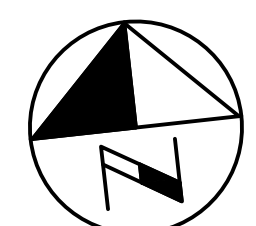

SIDE LINE 16 ROAD

PHASE 1
DRAINAGE

LEGEND

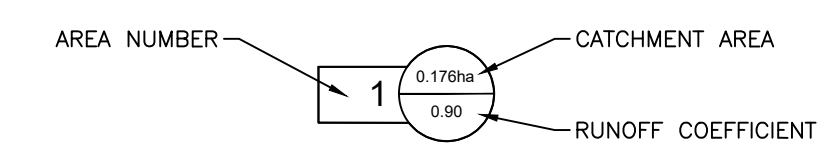

- | | |
|--|--------------------------------|
| | PROPOSED STORM CATCHMENT AREAS |
| | PROPOSED CATCH BASIN |
| | EXISTING STORM SEWER |
| | PROPOSED STORM SEWER |
| | FUTURE STORM SEWER |
| | PROPOSED SANITARY SEWER |
| | FUTURE SANITARY SEWER |
| | FUTURE WATERMAIN |
| | PROPOSED WATERMAIN |
| | PROPOSED STAGING LIMIT |
| | PROPOSED SWALE |
| | EXISTING WETLAND BOUNDARY |
| | EXISTING WETLAND SETBACK |
| | EXISTING PROPERTY LINE |
| | PROPERTY LINE SETBACK |
| | EXISTING BOREHOLE |
| | EXISTING UNDERGROUND GAS |
| | EXISTING OVERHEAD HYDRO |
| | EXISTING FENCE |
| | EXISTING MAJOR CONTOUR |
| | EXISTING MINOR CONTOUR |
| | EXISTING HYDRO POLE |
| | EXISTING DITCH LINE |
| | EXISTING EDGE OF PAVEMENT |

ALL MEASUREMENTS ARE TO BE VERIFIED BY THE CONTRACTOR ON SITE AND ANY DISCREPANCIES ARE TO BE REPORTED BEFORE PROCEEDING WITH THE WORK. THE REGION OF DURHAM ASSUMES NO RESPONSIBILITY FOR THE ACCURACY OF THE LOCATION OF EXISTING SERVICES AS INDICATED ON THIS DRAWING. DO NOT SCALE DRAWINGS.

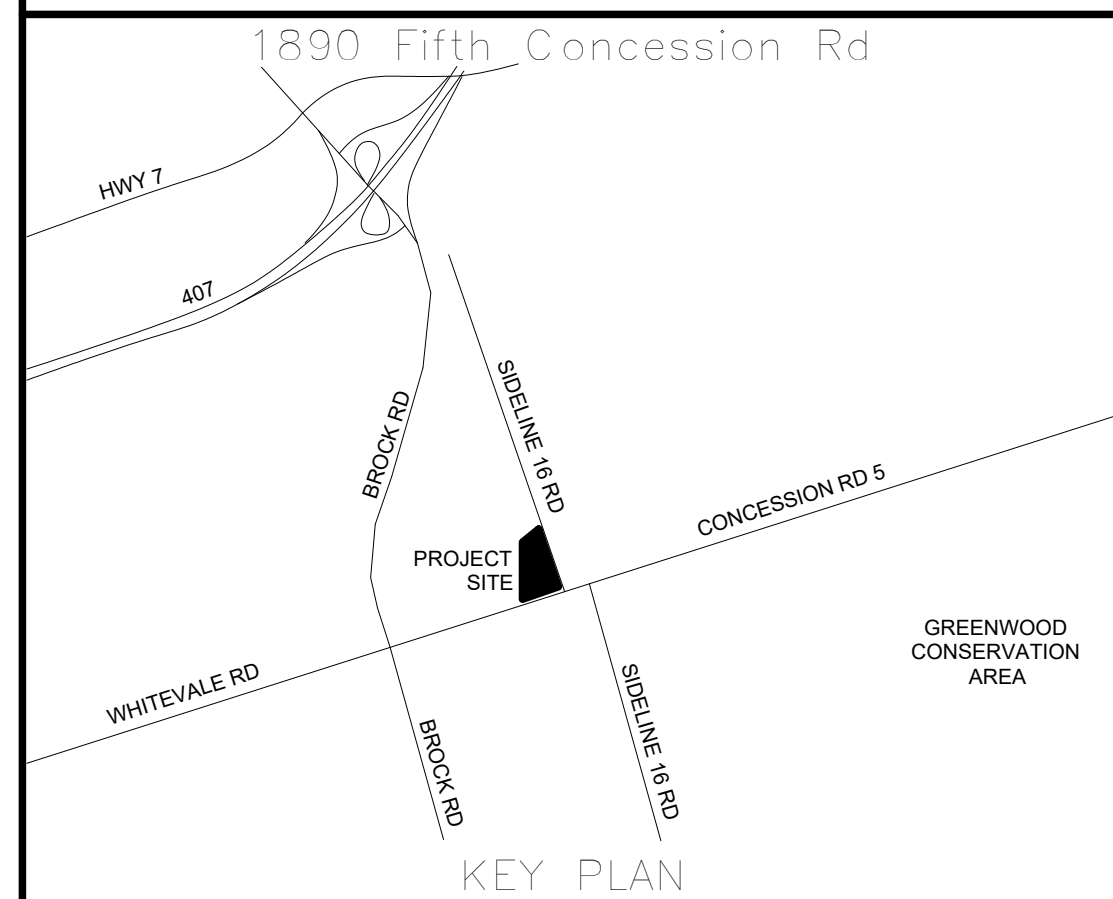
[illegible]

PRIME CONSULTANT



AECOM Canada Ltd.
50 Sportsworld Crossing Road, Suite 290
Kitchener, Ontario, N2P 0A4
519 650 5313 tel 519 650 3424 fax
www.aecom.com



SURVEY & BENCHMARK

SURVEY COMPLETED BY IBW SURVEYORS JULY 2018.

ALL ELEVATIONS ARE IN METERS. DISTANCES ARE GROUND AND CAN BE CONVERTED TO GRID BY MULTIPLYING BY THE COMBINED SCALE FACTOR OF 0.99986.

ELEVATIONS ARE GEODETIC AND REFERRED TO CITY OF PICKING BENCHMARK 4-031 AND HAVING A GEODETIC ELEVATION OF 151.957m.

DESIGN BY: SM	SCALE: 1:500
DRAWN BY: MB	DATE: 22 September, 2021
CHECKED BY: SM	CONSULTANT PROJECT NO. 60698928
APPROVED BY: -	CLIENT FILE No.: 811/20

CONTINUED REVISIONS				
	1	6/9/22/21	JC	ISSUED FOR TENDER
	NO.	DATE.	NAME	REVISIONS



THE REGIONAL MUNICIPALITY
OF DURHAM

NEW SEATON PARAMEDIC STATION
AND TRAINING FACILITY IN PICKERING
DRAINAGE AREAS

PROPERTY NO.	FACILITIES CODE	FACILITIES PROJECT NO. P061-18-01
CONTRACT NO. T-1160-2021	DRAWING NO. C-105	SHEET NO.